

SINGER®

Three-Thread Rolled Hem

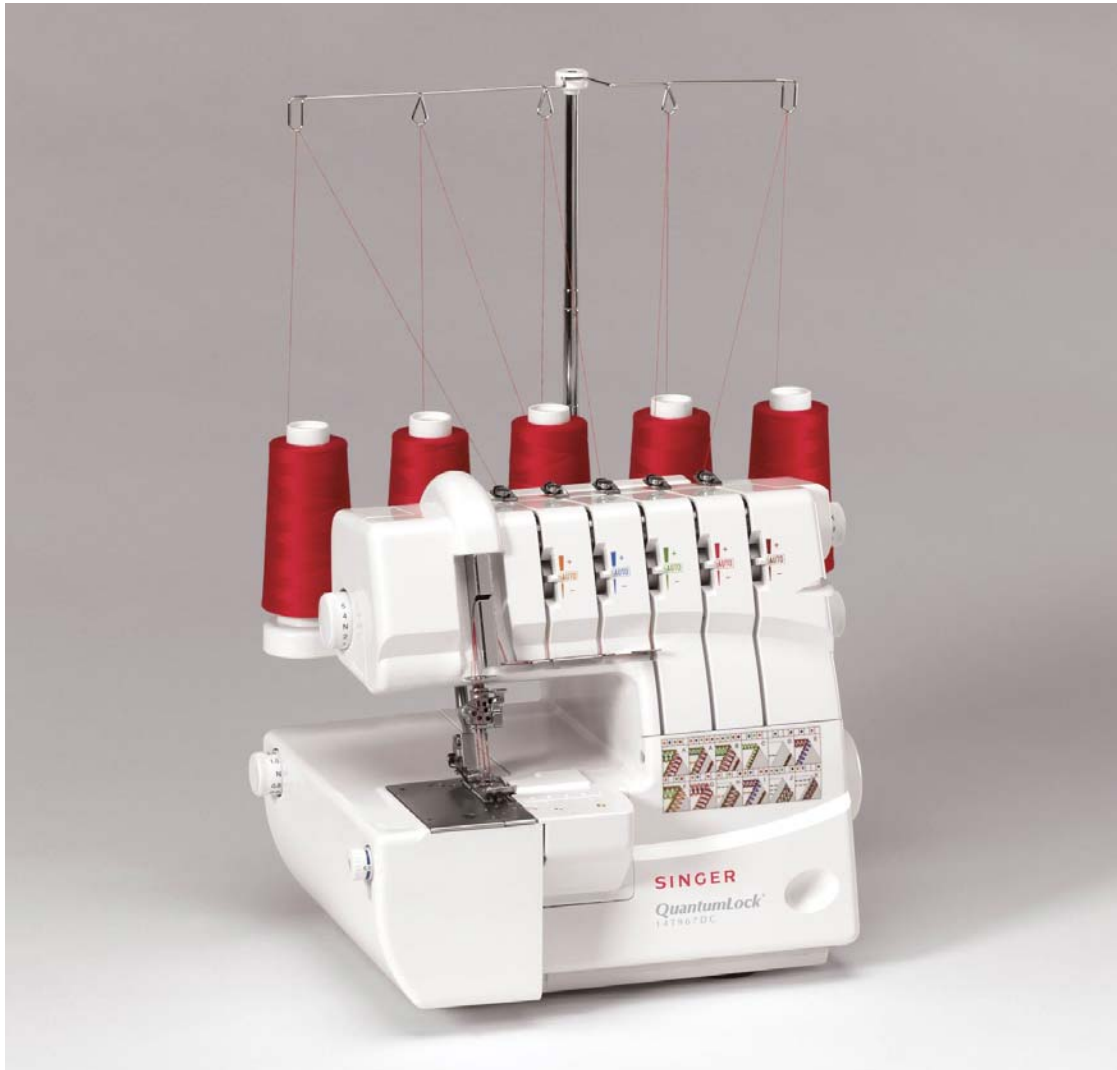

Three-Thread Rolled Hem

The Rolled Hem Stitch is used to finish edges of scarves, ruffles, table linens, and some garments. It is suitable for lightweight to medium weight fabrics, such as sheers, silkies and broadcloth. Beautiful pintucks can be achieved with the rolled hem. They can enhance a yoke, heirloom sewing, wearable art and even home decorating projects. Note: Rolled hemming can only be performed with the Right Overedge needle all other needles must be removed.

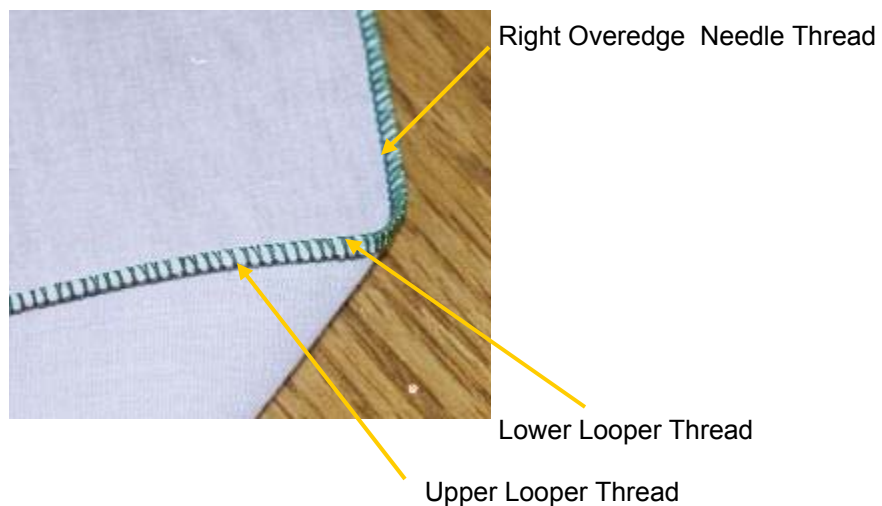
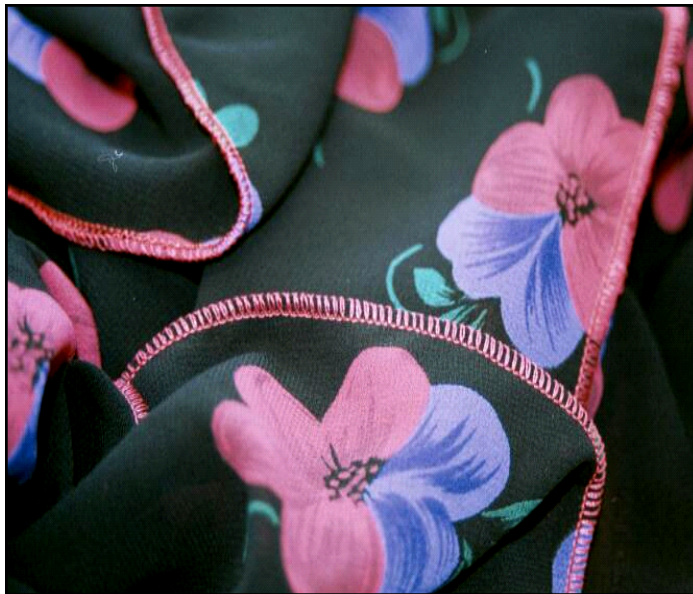

Set up:

Needles:

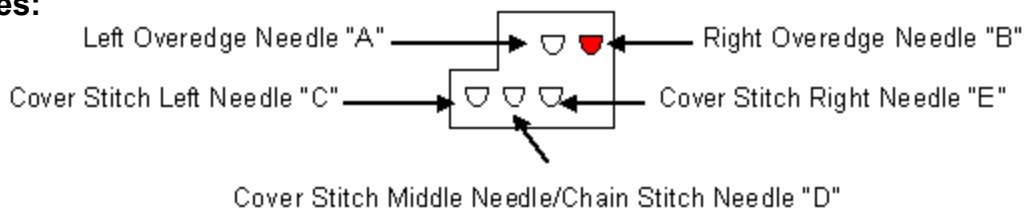

Set at:

ATD: Auto Tension Dial	"C"
Left Cover Stitch Needle "C"	Not Threaded
Middle Cover Stitch Needle "D"	Not Threaded
Right Cover Stitch Needle "E"	Not Threaded
Overedge Left Needle "A"	Not Threaded
Overedge Right Needle "B" (Blue)	Threaded
Upper Looper (Green)	Looper Engaged and Threaded
Spreader	Not Used
Lower Looper (Red)	Threaded
Chain Stitch Looper (Brown)	Not Threaded
Upper Looper Clutch	"L"
Upper Knife	Engaged
Seam Guide Plate	Not Installed Use Knife Cover
Seam Width Dial	"N"
Stitch Length Dial	"1"
Presser Foot Pressure	"N"
Differential Feed Dial	"N"
Stitch Finger	"R"

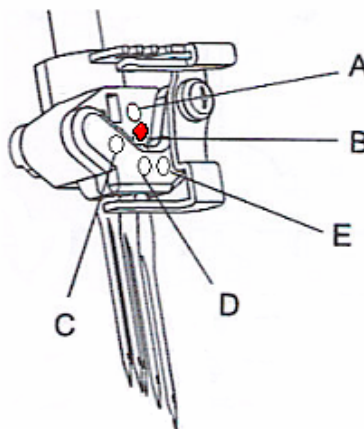

SINGER®

- ◆ Turn Auto Tension Dial to “C”.

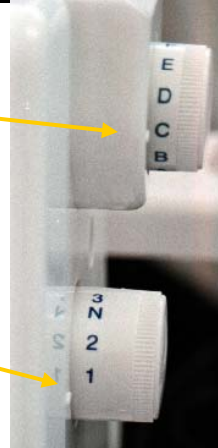

- ◆ Turn Stitch Length Dial to “1”.

- ◆ Engage Upper Knife. The knife will not trim the fabric when it is disengaged.
 1. Open Looper Cover.
 2. Pull the movable knife holder (silver screw) to the right as far as it will go.
 3. Turn the holder clockwise until the knife clicks into a lock position.

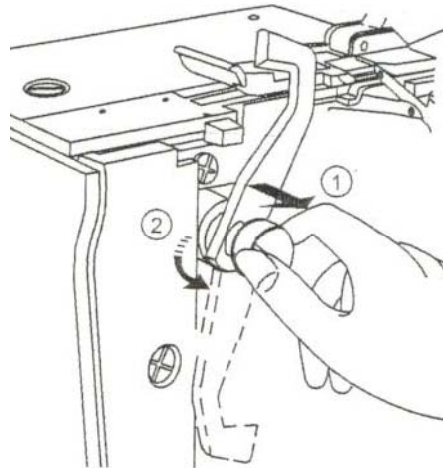

Upper Knife Disengaged



Upper Knife Engaged

SINGER®

- ◆ Turn Presser Foot Pressure Dial to “N”.



- ◆ Turn Differential Feed Dial to “N”.



- ◆ Turn Seam Width Dial to “N”.



- ◆ Set Stitch Finger to “R”.



SINGER®

◆ Install the Knife Cover.

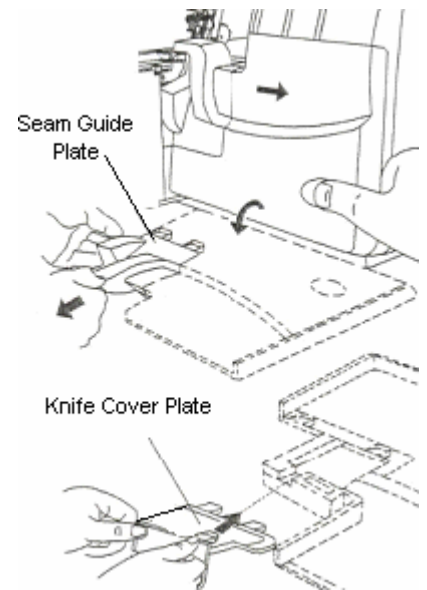

◆ Engage Upper Looper. Engaging the Upper Looper causes the looper to move when sewing. Even though the Upper Looper is not threaded it needs to be engaged.

1. Push the clutch button to the left and down to engage.
2. Turn handwheel.

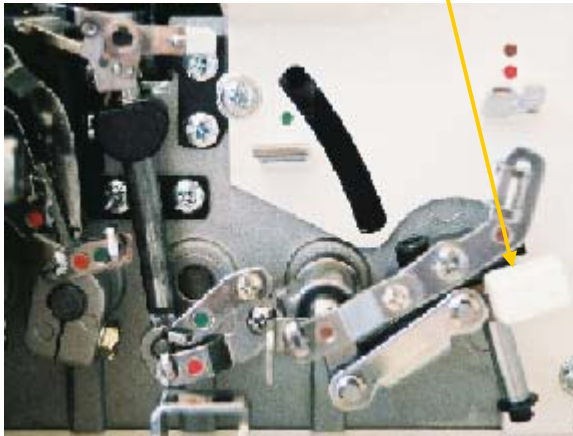

Upper Looper Disengaged

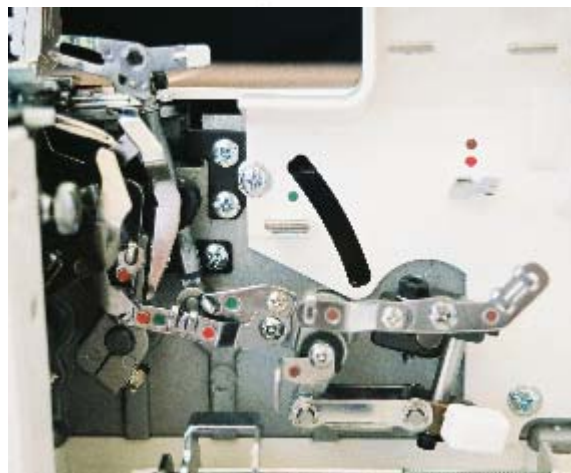
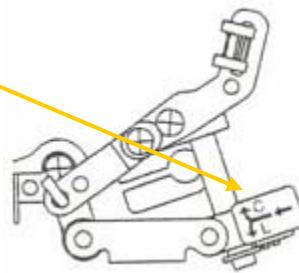

Upper Looper Engaged

- ◆ Disengage Spreader. The Upper Looter has a hole for the thread on the top of the looper. If the stitch requires that the looper be engaged, but not threaded then the Spreader is used. The Spreader simply plugs-in (or closes) the looper's hole. The Spreader is disengaged when the Upper Looter is engaged/operative and threaded. The Spreader is used with a stitch that requires only one looper thread. With the help of the Spreader the single looper thread wraps around the fabric's edge.
 1. Lower the white handle on the Spreader to open the eye of the Upper Looter.

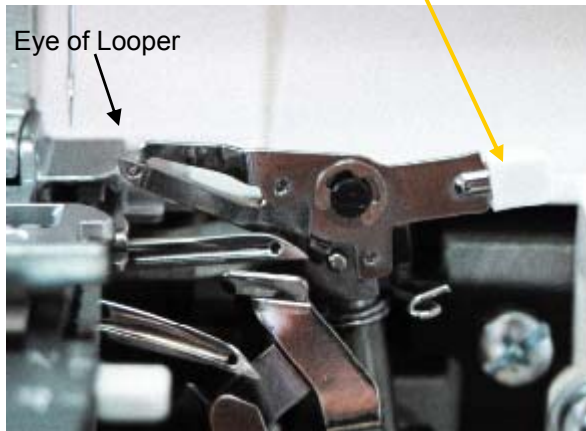

Spreader Engaged



Spreader Disengaged

- ◆ Thread Upper Looter with regular overlock thread.

1. Raise the Presser Foot to release the tension disks. Thread the Lower Looter as illustrated 1-9.

2. Pass thread from back to the front through the thread guide ①.

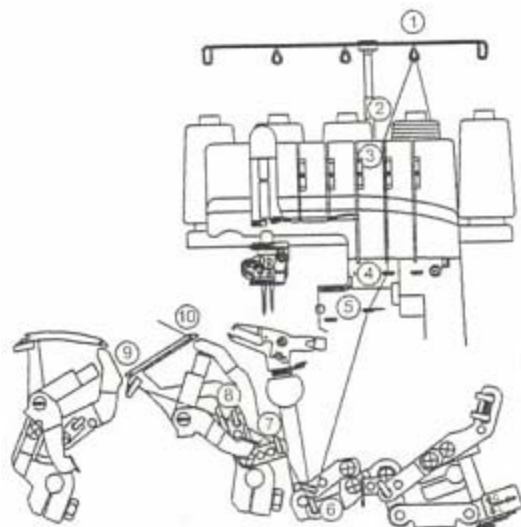
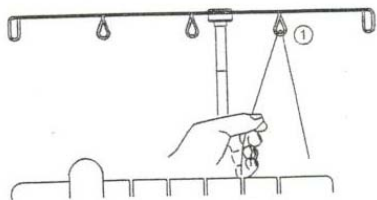

3. Thread the top cover thread guide by pulling the thread towards the left until it slips under the guide. Then pull the thread along the right side of the button as illustrated.

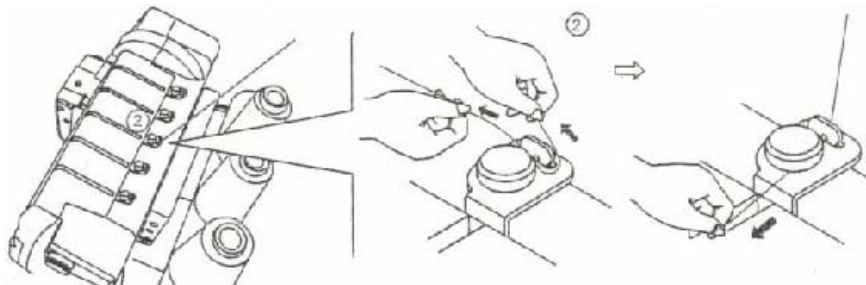

4. While holding the thread firmly, pull the thread between the tension disks.

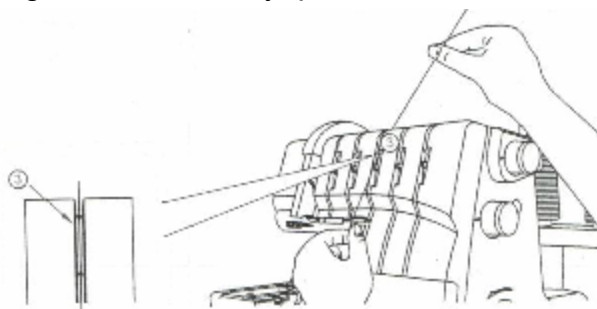

5. Turn the handwheel toward you until the lower looper extends 5-10mm (approximately 1/2 inch) from the needle plate edge.

6. Thread the looper area of the machine following the green color coded thread guides 4-9.

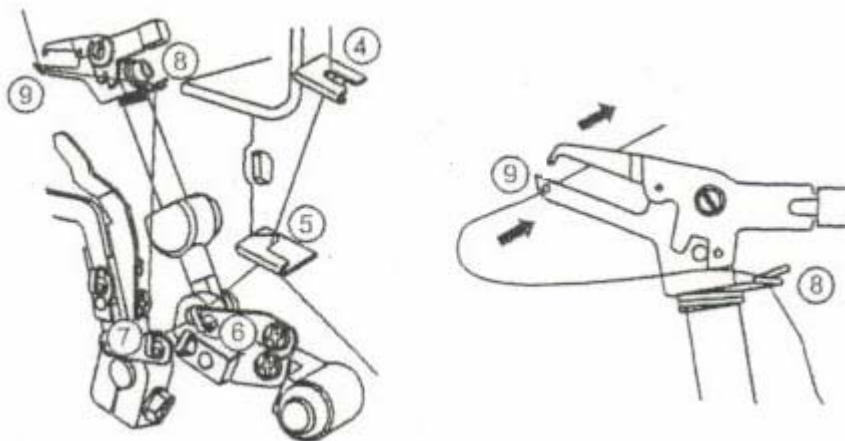

7. Thread the hole in the Upper Looter from front to back ⑨. Pull about 4 inches of thread through the looper and place to the back of the throat plate.

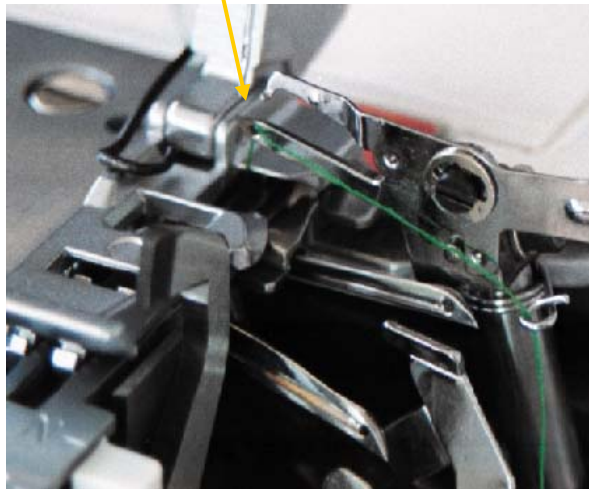

◆ Thread Lower Looter with regular overlock thread.

1. Raise the Presser Foot to release the tension disks. Thread the Lower Looter as illustrated 1-10.
2. Pass thread from back to the front through the thread guide ①.

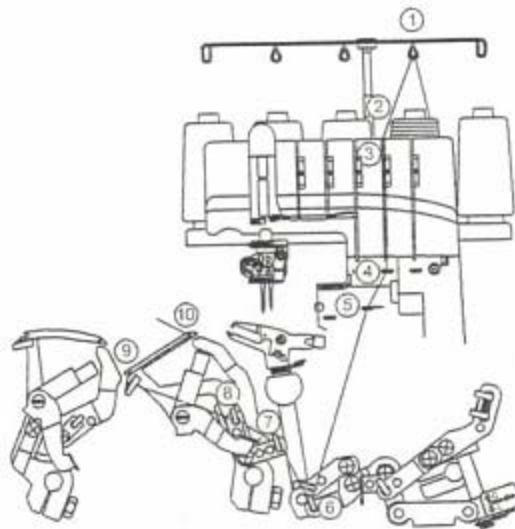
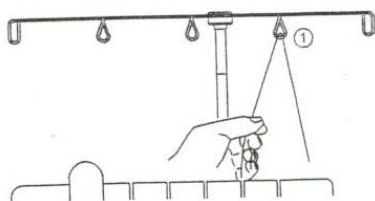

3. Thread the top cover thread guide by pulling the thread towards the left until it slips under the guide. Then pull the thread along the right side of the button as illustrated.

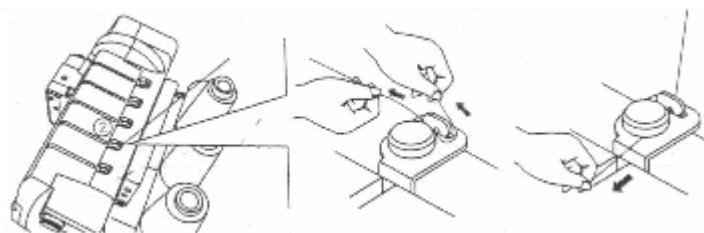

4. While holding the thread firmly, pull the thread between the tension disks.

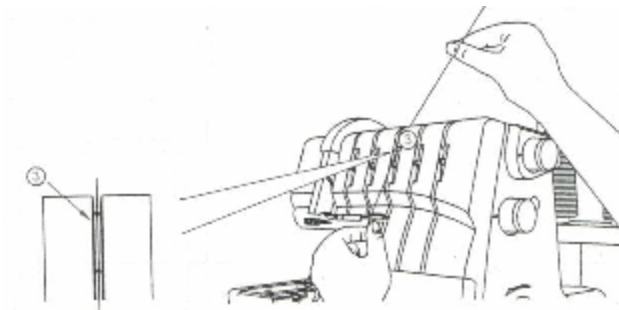

5. Turn the handwheel toward you until the lower looper extends 5-10mm (approximately ½ inch) from the needle plate edge.
6. Thread the looper area of the machine following the red color coded thread guides 4-10.

7. Place the thread slightly from left and to the right of threading guide ④.

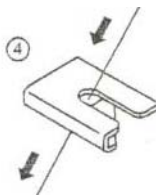

8. Place the thread slightly from the front and to the back of threading guide ⑤.

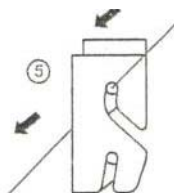

9. Place the thread through ⑥, ⑦ and ⑧.

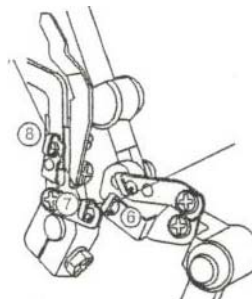

10. Thread the looper eye (A) from front to back. Pull about 4 inches of thread. Position thread into V cutout (B) on threader. Firmly hold thread tail with left hand and pull Threader lever (C) up into place (D).

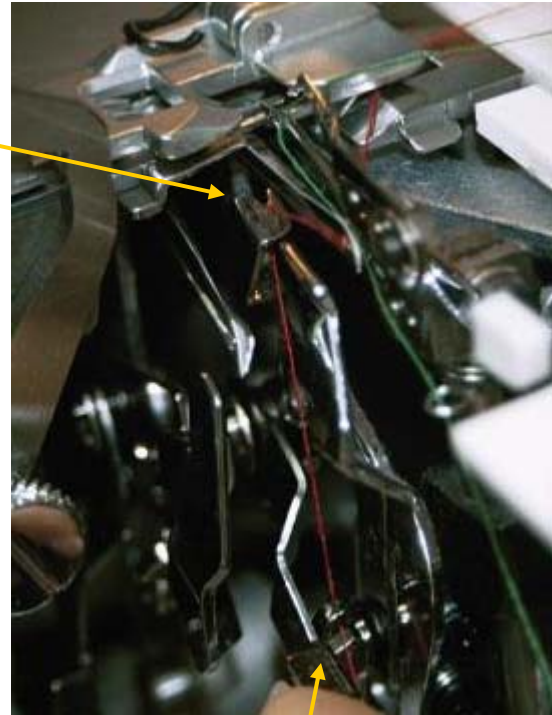
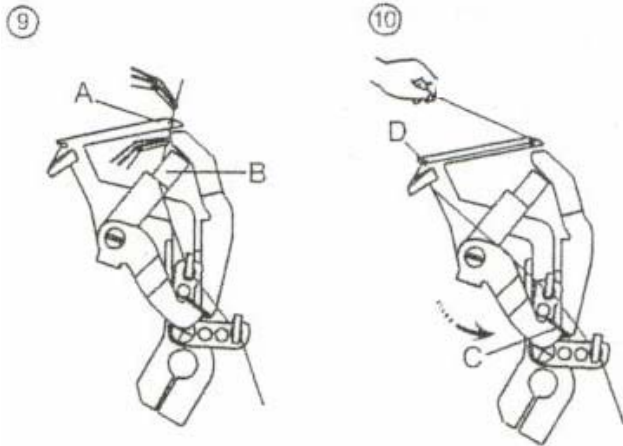

Threader Lever



NOTE: Make sure the Upper Looper thread is behind the Lower Looper thread.

◆ Thread Right Overedge needle with regular overlock thread.

1. Raise the Presser Foot to release the tension disks. Thread the right needle as illustrated 1-9.

2. Pass thread from back to the front through the thread guide ①.

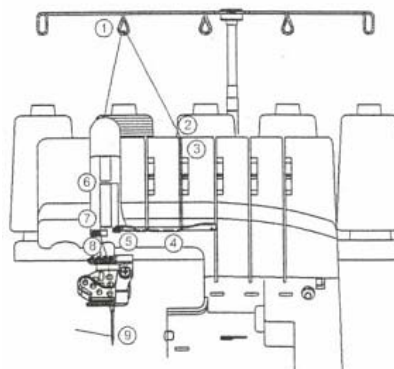
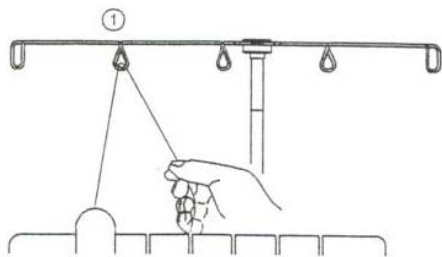

3. Thread the top cover thread guide by pulling the thread towards the left until it slips under the guide. Then pull the thread along the right side of the button as illustrated.

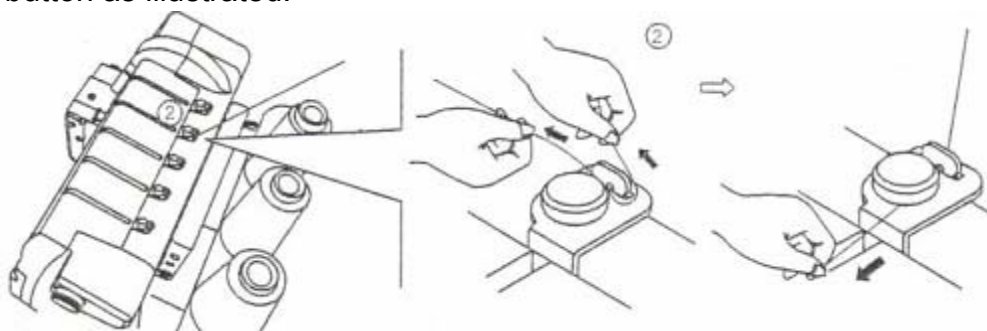

4. While holding the thread firmly, pull the thread between the tension disks.

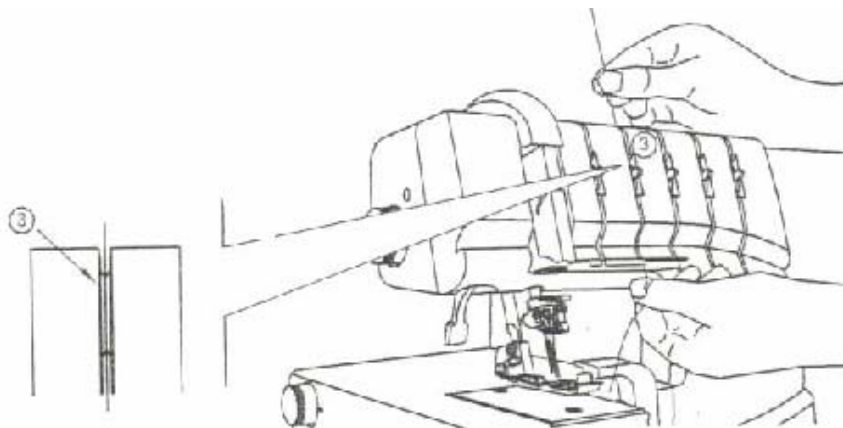

SINGER®

5. Continue to thread points 4-8. Slip the thread into the rear slot of the thread guide ⑤. Go over the take up lever ⑥. Continue by slipping the thread into the right slots of the thread guides ⑦ and ⑧.
8. Before threading the eye of the needle, make sure the thread is behind the thread guide located on the bottom of the needle clamp.

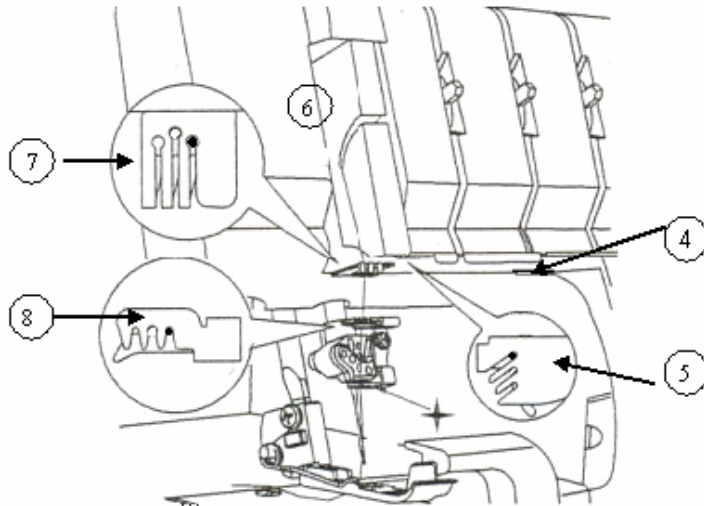

9. Draw about 4 inches of the thread through the needle eye towards the back of the machine.
10. Place the thread to the back, under the Presser Foot. Lower foot and sew.

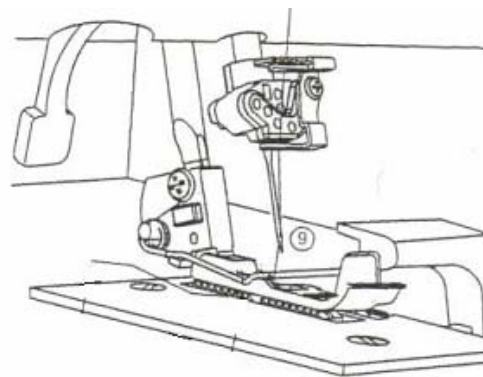

SINGER®

Try It:

- ◆ Align a piece of lightweight fabric so that the fabric's edge is being slightly trimmed by the knife.
- ◆ Sew.

