

SINGER®

Three-Thread Flatlock (Narrow and Wide)

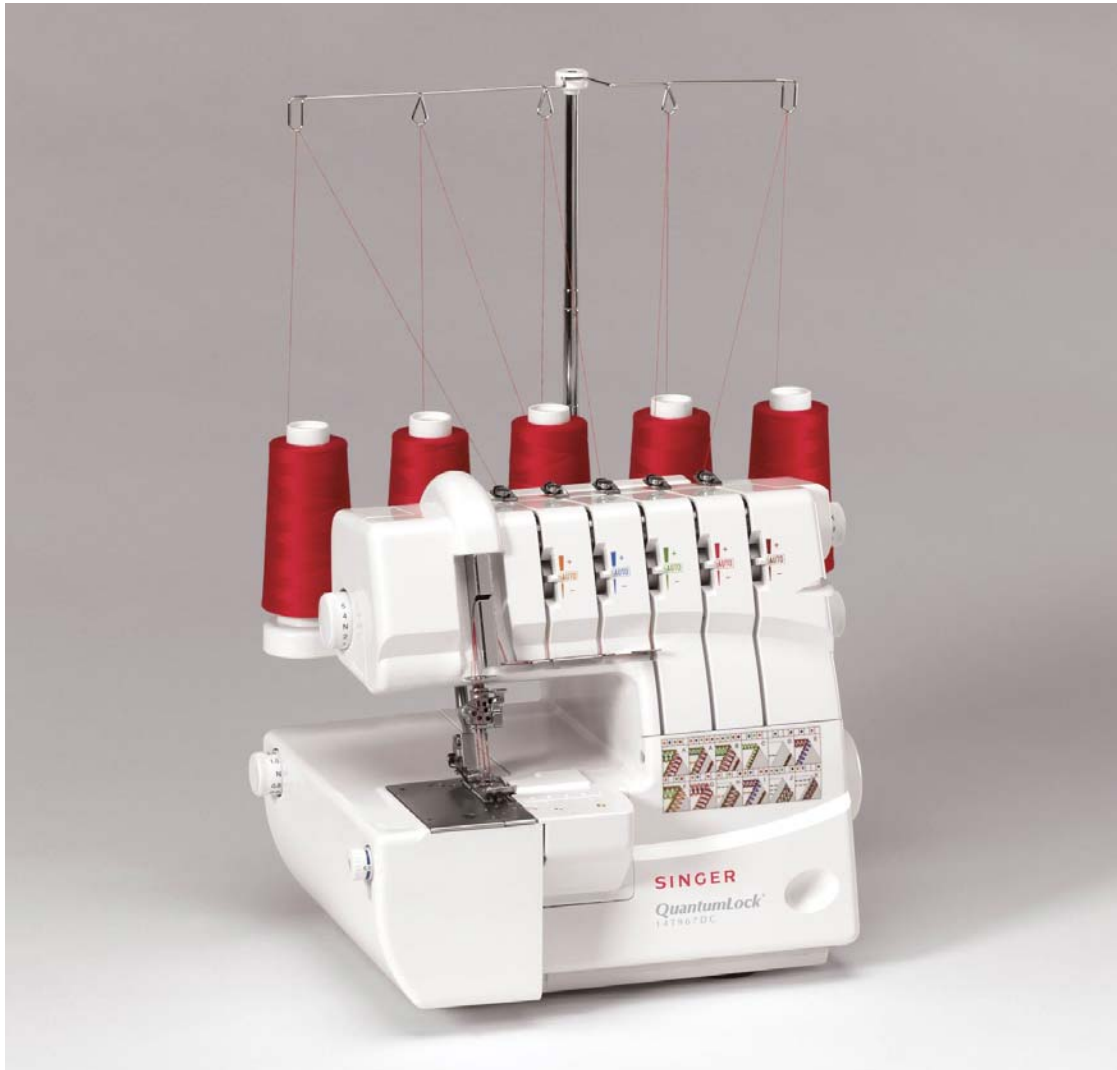

Three-Thread Flatlock (Narrow)

The Flatlock Stitch is used decoratively to achieve the look of applied trim on a garment, craft or home decorator projects. Special decorative threads are used for a textured and dramatic embellishment effect. The Flatlock Stitch can also be used to serge non-bulky seams. The Flatlock Stitch is sewn with one needle and the upper and lower loopers. Both sides of the Flatlocking Stitch are considered decorative. The decorative loop effect is achieved when the Flatlock seams are stitched with the fabrics wrong sides together. The ladder stitch is achieved when the Flatlock seams are stitched with the fabrics right sides together. There are 2 different ways to set up for a Three-Thread Flatlock stitch. For a more narrow stitch (4.0) select the right overedge needle; for a wider stitch (6.0) the left overedge needle is used.



Set up:

Needle:

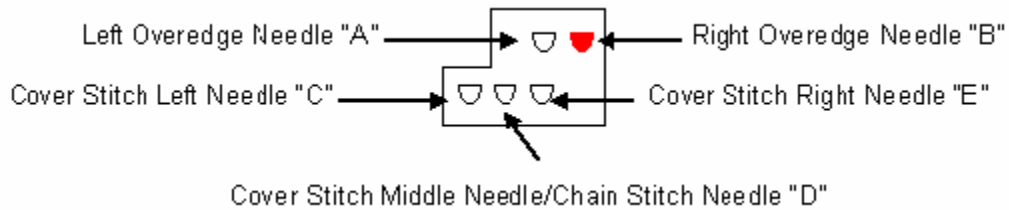

Set Up:

ATD: Auto Tension Dial	"F"
Left Cover Stitch Needle "C"	Unthreaded and Remove Needle
Middle Cover Stitch Needle "D"	Unthreaded and Remove Needle
Right Cover Stitch Needle "E"	Unthreaded and Remove Needle
Overedge Left Needle "A"	Unthreaded and Remove Needle
Overedge Right Needle "B" (Blue)	Threaded
Upper Looper (Green)	Looper Engaged and Threaded
Spreader	Disengaged
Lower Looper (Red)	Threaded
Chain Stitch Looper (Brown)	Unthreaded
Upper Knife	Engaged
Seam Guide Plate	Not Installed, use Knife Cover Plate
Seam Width Dial	"N"
Stitch Length Dial	"2"
Presser Foot Pressure	"N"
Differential Feed Dial	"N"
Stitch Finger	"N"

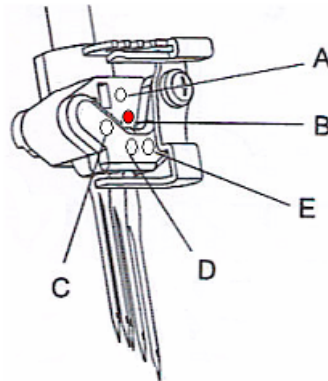



The Flatlock stitch, with fabric's right sides together, form a ladder stitch. A ribbon can then be woven by hand in and out of the stitches. The ladder stitch is ideal for joining laces together, as seen in heirloom sewing. Another idea for the ladder stitch is to use decorative thread through the needle to form a bold embellishment to projects.



SINGER®



- ◆ Turn Auto Tension Dial to “F”.

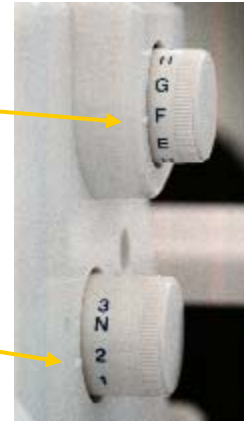

- ◆ Turn Stitch Length Dial to “2”.

- ◆ Engage Upper Knife. The knife will not trim the fabric when it is disengaged.
 1. Open Looper Cover.
 2. Pull the movable knife holder (silver screw) to the right as far as it will go.
 3. Turn the holder clockwise until the knife clicks into a lock position.

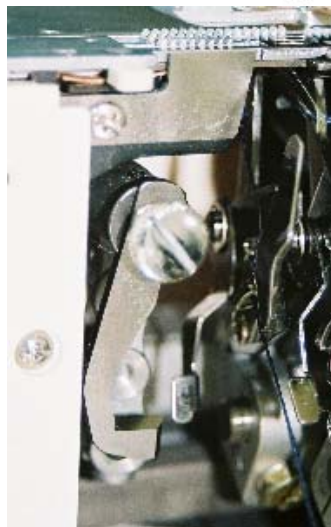
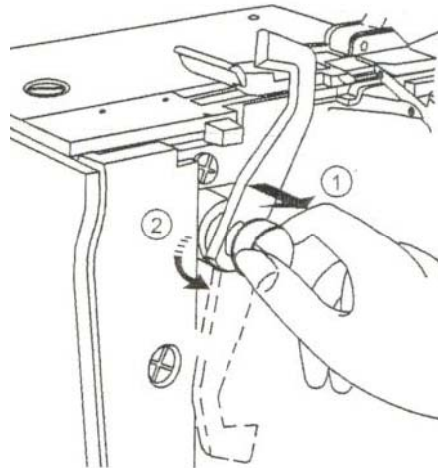

Upper Knife Disengaged



Upper Knife Engaged

- ◆ Turn Presser Foot Pressure to “N”.



- ◆ Turn Differential Feed Dial to “N”.



- ◆ Turn Seam Width Dial to “N”.

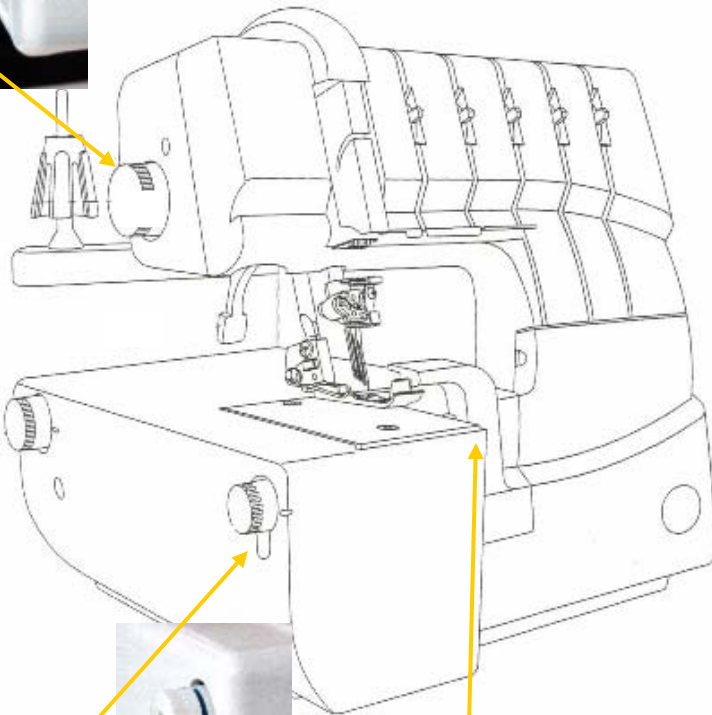

- ◆ Set Stitch Finger to “N”.

SINGER®

◆ Install the Knife Cover.

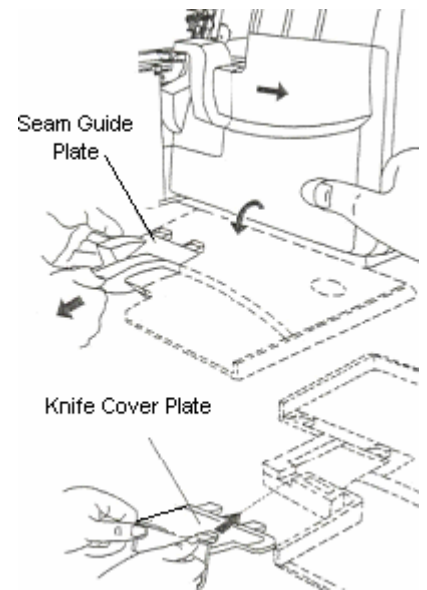

◆ Engage Upper Looper. Engaging the Upper Looper causes the looper to move when sewing. Even though the Upper Looper is not threaded it needs to be engaged.

1. Push the clutch button to the left and down to engage.
2. Turn handwheel.

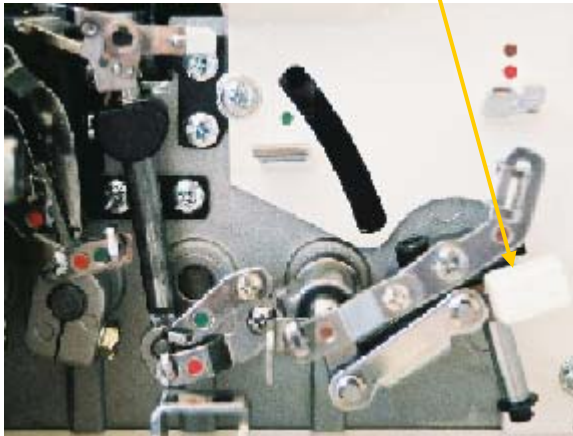

Upper Looper Disengaged

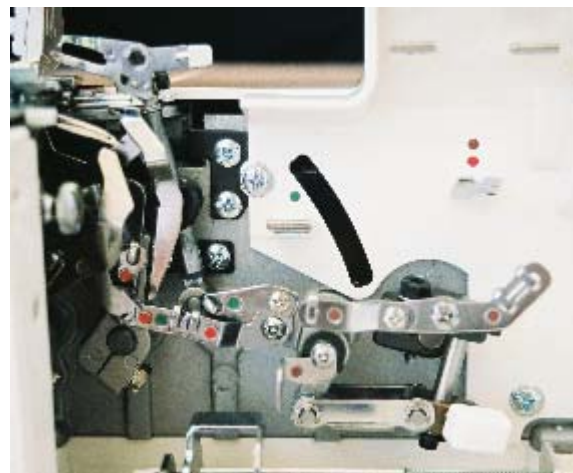
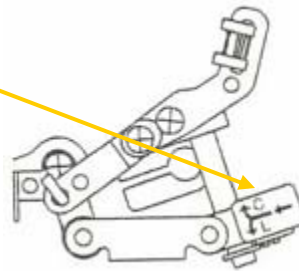

Upper Looper Engaged

- ◆ Disengage Spreader. The Upper Loper has a hole for the thread on the top of the looper. If the stitch requires that the looper be engaged but not threaded then the Spreader is used. The Spreader simply plugs-in (or closes) the looper's hole. The Spreader is disengaged when the Upper Loper is engaged/operative and threaded. The Spreader is used with a stitch that requires only one looper thread. With the help of the Spreader the single looper thread wraps around the fabric's edge.

1. Lower the white handle on the Spreader to open the eye of the Upper Loper.

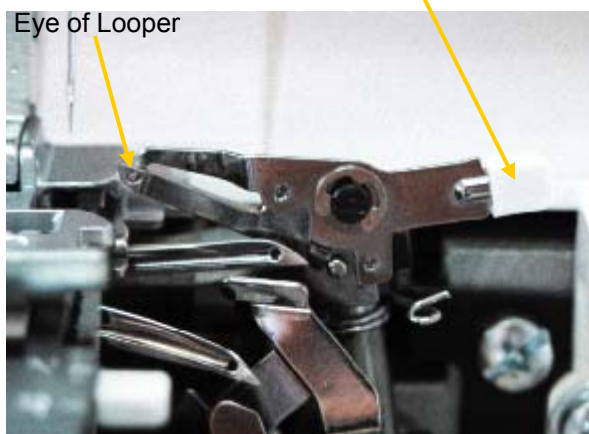

Spreader Engaged



Spreader Disengaged

- ◆ Thread Upper Loper with regular overlock thread.

1. Raise the Presser Foot to release the tension disks. Thread the Lower Loper as illustrated 1-9.

2. Pass thread from back to the front through the thread guide ①.

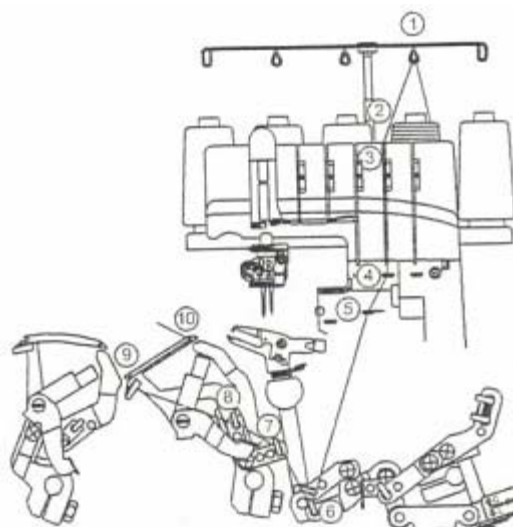
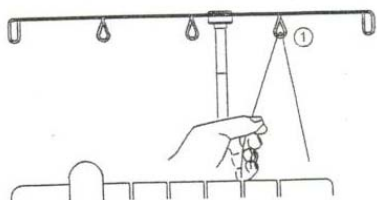

3. Thread the top cover thread guide by pulling the thread towards the left until it slips under the guide. Then pull the thread along the right side of the button as illustrated.

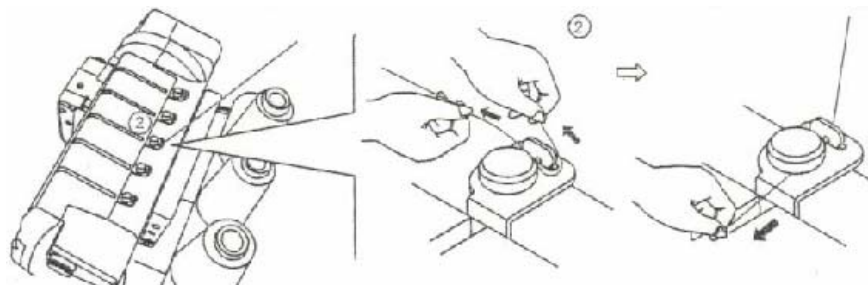

4. While holding the thread firmly, pull the thread between the tension disks.

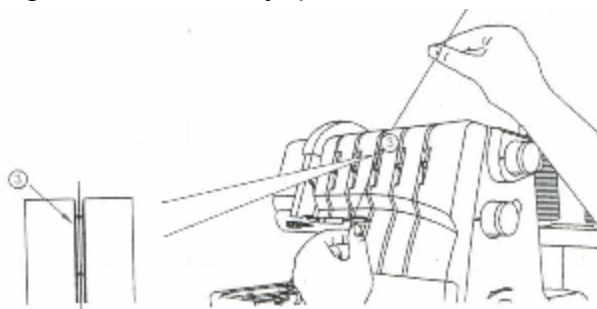

5. Turn the handwheel toward you until the lower looper extends 5-10mm (approximately ½ inch) from the needle plate edge.
6. Thread the looper area of the machine following the green color coded thread guides 4-9.

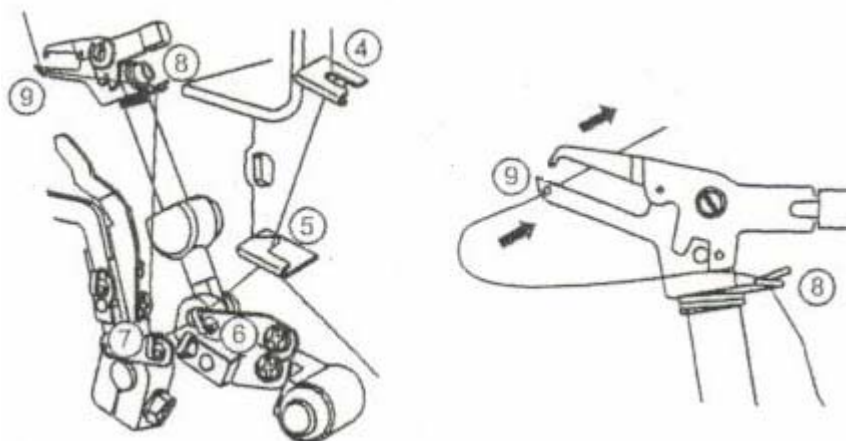

7. Thread the hole in the Upper Looter from front to back ⑨. Pull about 4 inches of thread through the looper and place to the back of the throat plate.

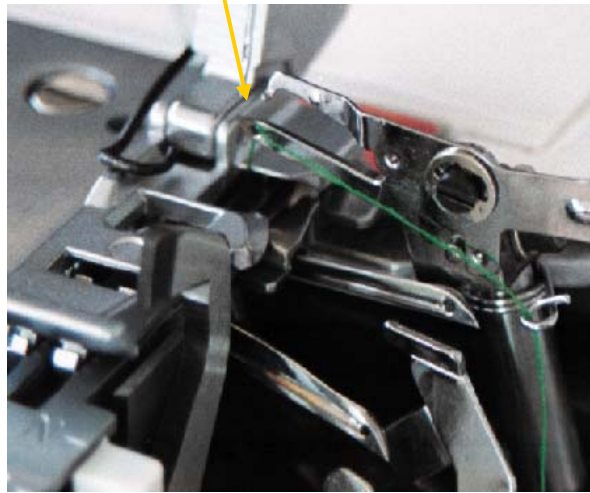

◆ Thread Lower Looter with regular overlock thread.

1. Raise the Presser foot to release the Tension disks. Thread the Lower Looter as illustrated 1-10.
2. Pass thread from back to the front through the thread guide ①.

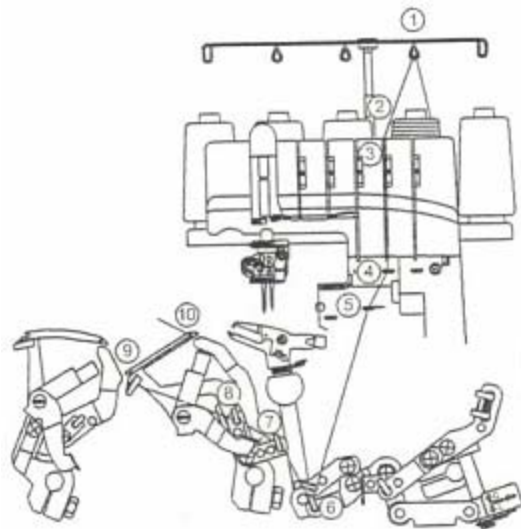
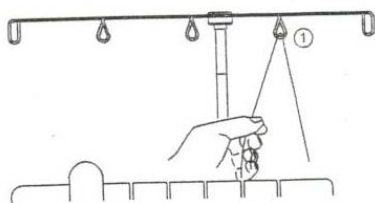

3. Thread the top cover thread guide by pulling the thread towards the left until it slips under the guide. Then pull the thread along the right side of the button as illustrated.

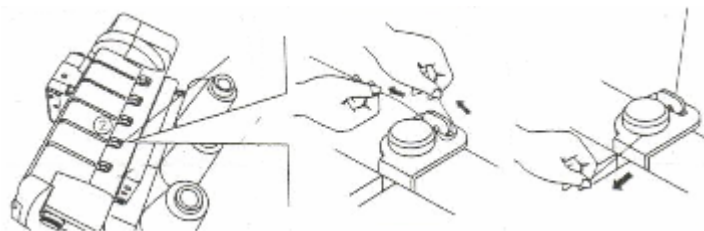

10. Thread the looper eye (A) from front to back. Pull about 4 inches of thread. Position thread into V cutout (B) on threader. Firmly hold thread tail with left hand and pull Threader lever (C) up into place (D).

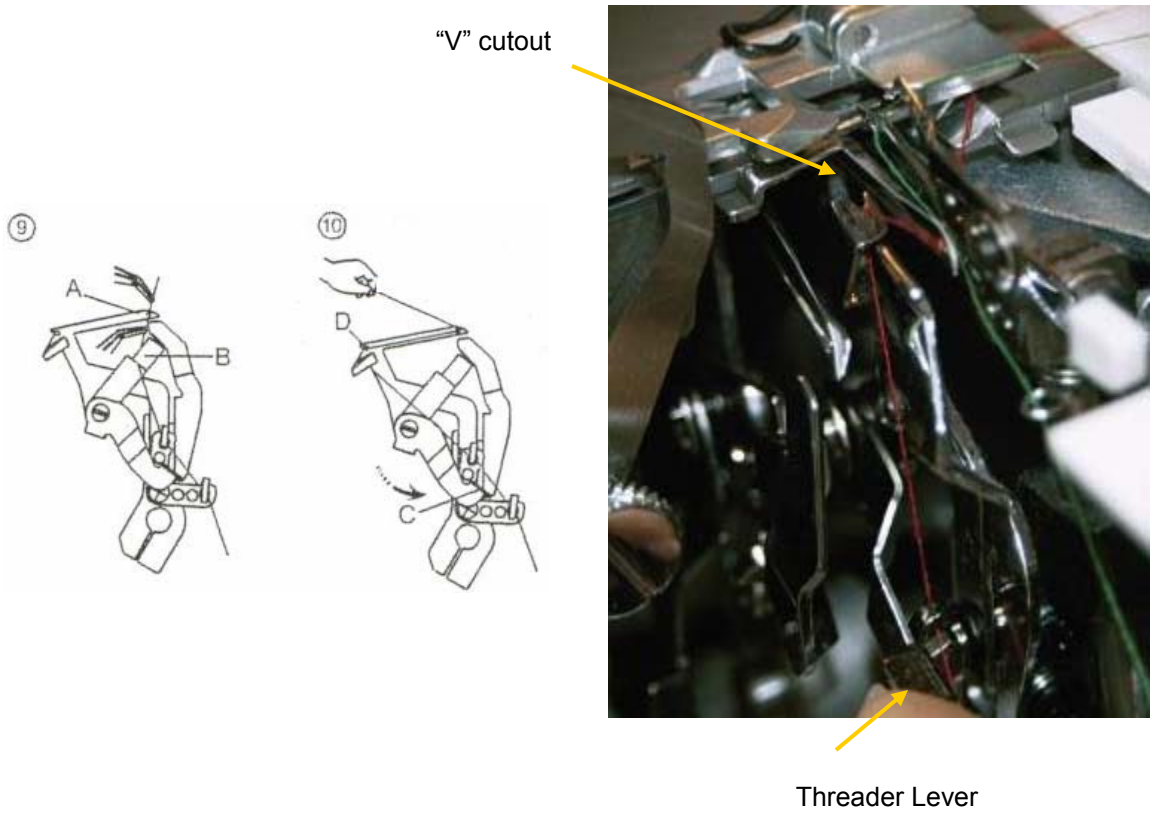

NOTE: Make sure the Upper Looper thread is behind the Lower Looper thread.

◆ Thread Right Overedge needle with regular overlock thread.

1. Raise the Presser Foot to release the tension disks. Thread the right needle as illustrated 1-9.

2. Pass thread from back to the front through the thread guide ①.

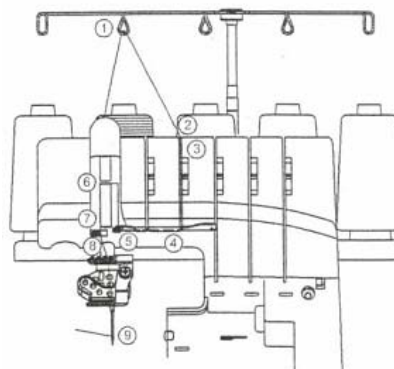
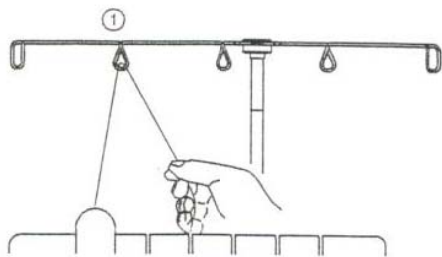

3. Thread the top cover thread guide by pulling the thread towards the left until it slips under the guide. Then pull the thread along the right side of the button as illustrated.

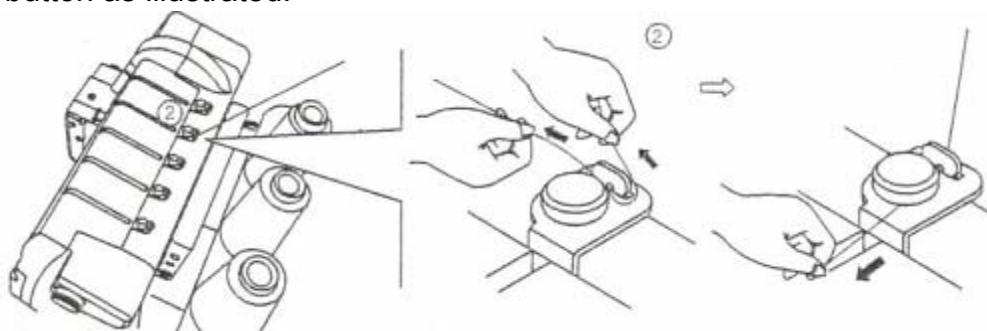

4. While holding the thread firmly, pull the thread between the tension disks.

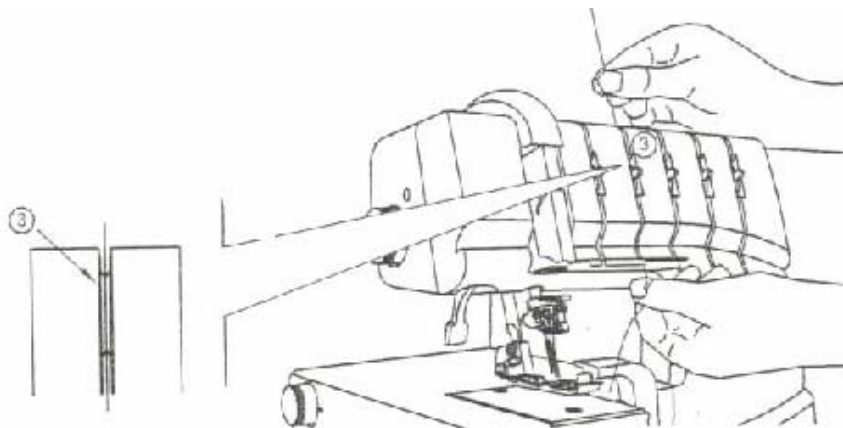

SINGER®

5. Continue to thread points 4-8. Slip the thread into the rear slot of the thread guide ⑤. Go over the take up lever ⑥. Continue by slipping the thread into the right slot of the thread guides ⑦ and ⑧.
8. Before threading the eye of the needle, make sure the thread is behind the thread guide located on the bottom of the needle clamp.

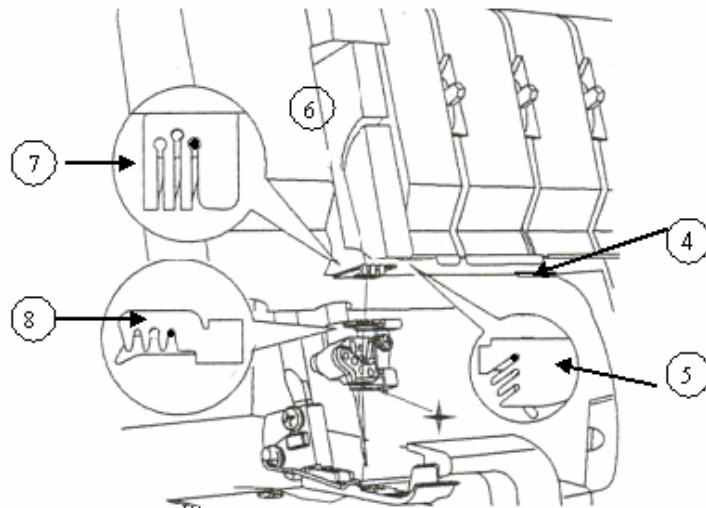

9. Draw about 4 inches of the thread through the needle eye towards the back of the machine.
10. Place the thread to the back, under the Presser Foot.

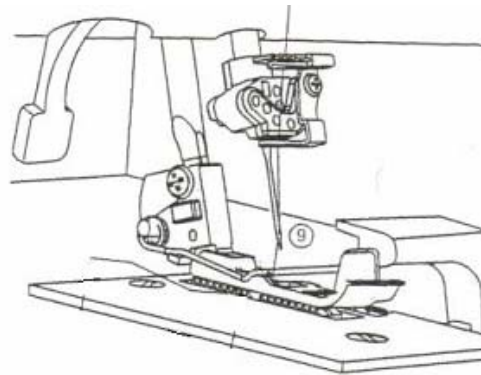

SINGER®

Try It:

- ◆ Fold T-shirt interlock fabric wrong sides together lengthwise.
- ◆ Align the fabric so that the fabric's fold is not being trimmed by the knife.
- ◆ Sew.
- ◆ Gently pull the fabric flat and press.

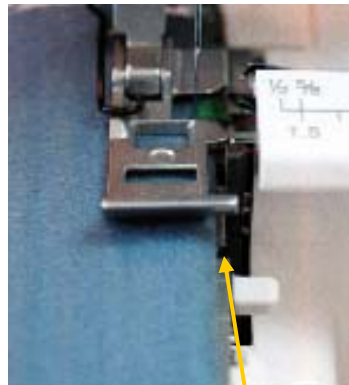
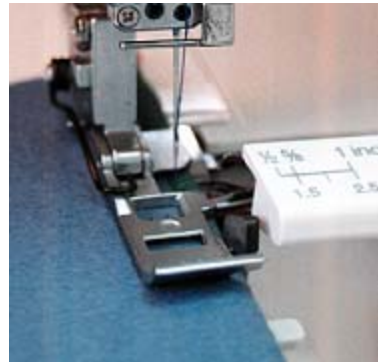

Hint:
If the fabric is not laying flat, align
the fabric farther to the left of the
knife.

Three-Thread Flatlock (Wide)

The Three-Thread Flatlock (wide) has the same set up as the Three-Thread Flatlock (narrow) Stitch. The only exception is the Right Overedge Needle is now unthreaded and removed and the Left Overedge Needle is threaded. By using the left needle, the stitch becomes wider.

Left Overedge Needle Thread

Right Overedge Needle Thread



Set up:

Needle:

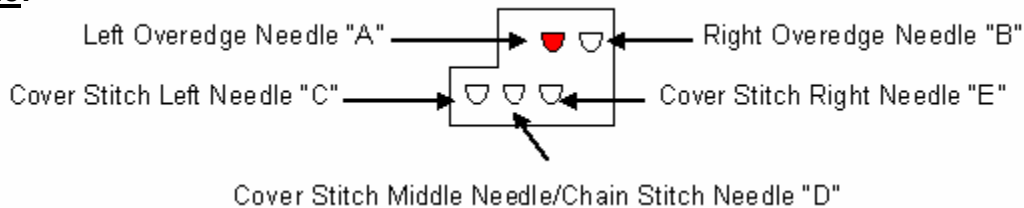

Set at:

ATD: Auto Tension Dial	"F"
Left Cover Stitch Needle "C"	Unthreaded and Remove Needle
Middle Cover Stitch Needle "D"	Unthreaded and Remove Needle
Right Cover Stitch Needle "E"	Unthreaded and Remove Needle
Overedge Left Needle "A" (Orange)	Threaded
Overedge Right Needle "B"	Unthreaded and Remove Needle
Upper Looper (Green)	Looper Engaged and Threaded
Spreader	Disengage
Lower Looper (Red)	Threaded
Chain Stitch Looper (Brown)	Unthreaded
Upper Knife	Engaged
Seam Guide Plate	Not Installed, use Knife Cover Plate
Seam Width Dial	"N"
Stitch Length Dial	"2"
Presser Foot Pressure	"N"
Differential Feed Dial	"N"
Stitch Finger	"N"

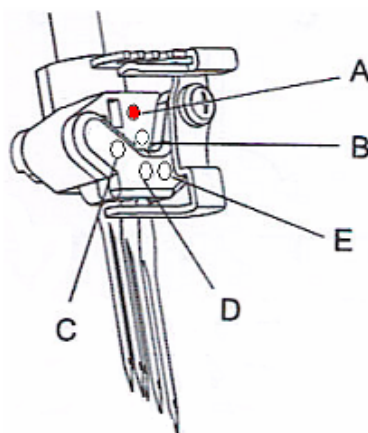

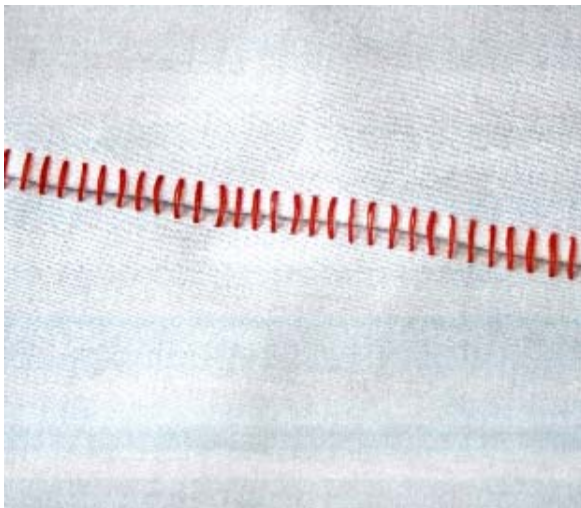
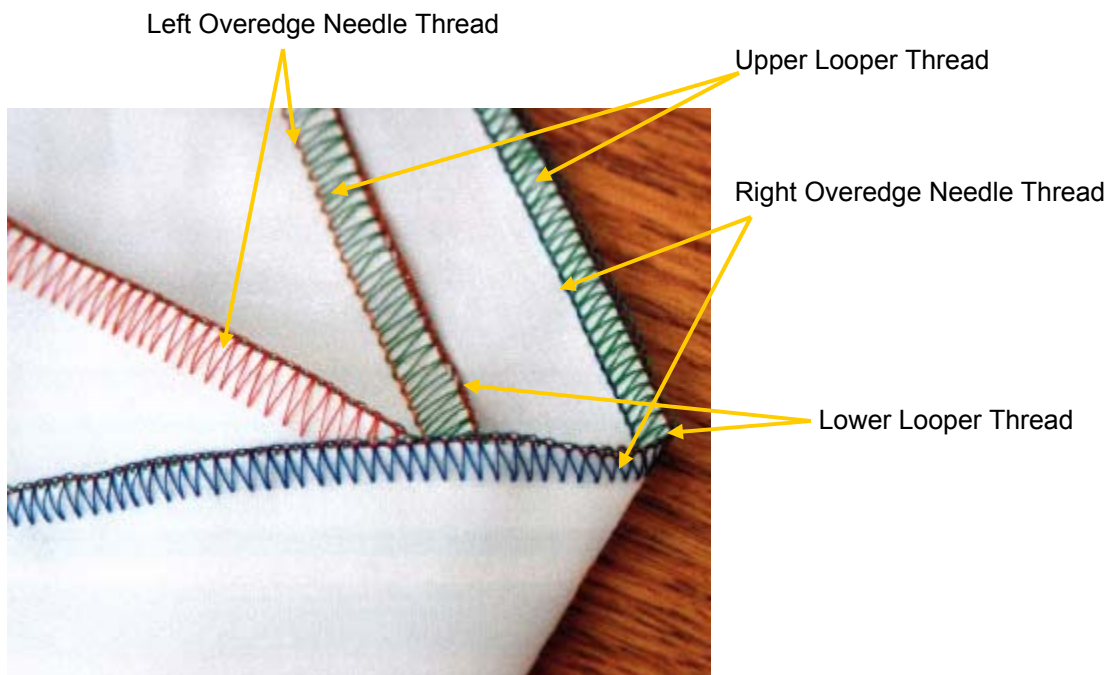

Decorative Ladder Effect (wide)
Fabric Right Sides Together

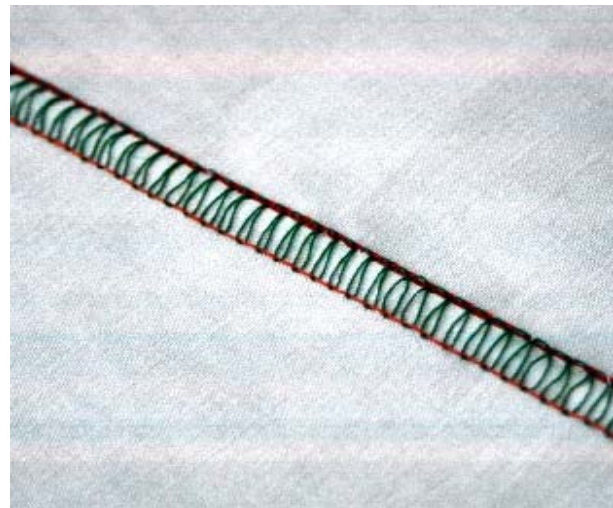

Decorative Loop Effect (wide)
Fabric Wrong Sides Together

◆ Thread Left Overlock needle with regular thread.

1. Raise the Presser Foot to release the tension disks. Thread the left needle as illustrated 1-9.

2. Pass thread from back to the front through the thread guide ①.

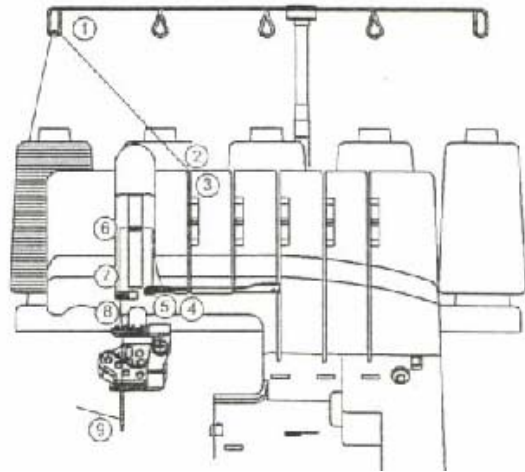
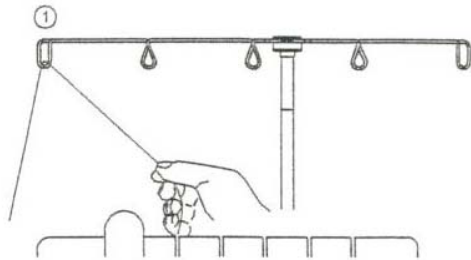

3. Thread the top cover thread guide by pulling the thread towards the left until it slips under the guide. Then pull the thread along the right side of the button as illustrated.

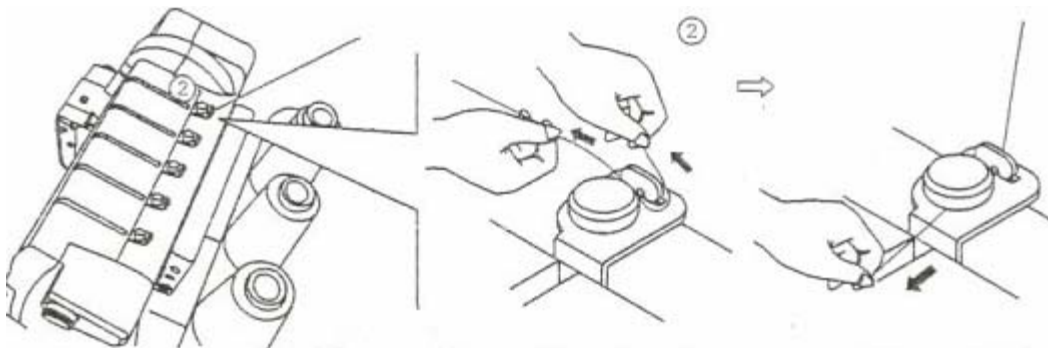

4. While holding the thread firmly, pull the thread between the tension disks.

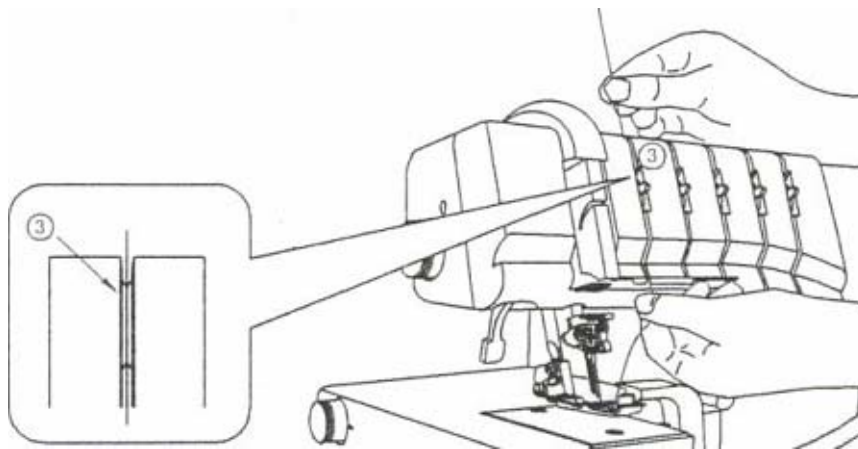

5. Continue to thread points 4-8. Slip the thread into the middle slot of the thread guide ⑤. Go over the take up lever ⑥. Continue by slipping the thread into the middle slot of the thread guides ⑦ and ⑧.
6. Before threading the eye of the needle, make sure the thread is behind the thread guide located on the bottom of the needle clamp.

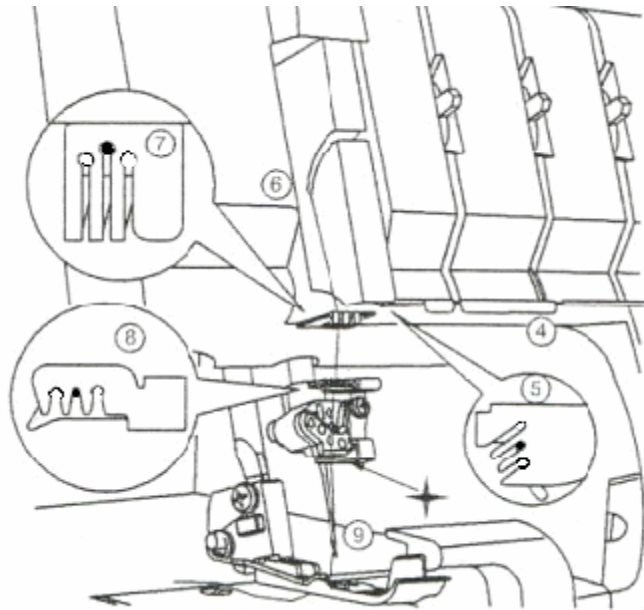

7. Thread the eye of the left needle ⑨.

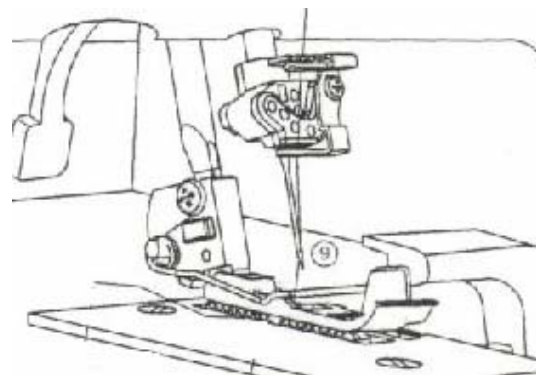
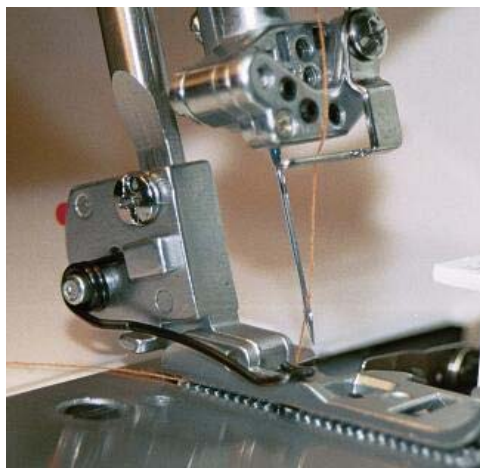

8. Draw about 4 inches of the thread through the needle eye towards the back of the machine.
9. Place the thread to the back, under the Presser Foot. Lower foot and sew.

Try It:

- ◆ Fold sweatshirt fabric wrong sides together, lengthwise.
- ◆ Align the fabric so that the fabric's fold is not being trimmed by the knife.
- ◆ Sew.
- ◆ Gently pull the fabric flat and press.



Hint:
If the fabric is not laying flat, align
the fabric farther to the left of the
knife.