

SINGER®

Two-Thread Wrapped Edge Overlock (Narrow and Wide)

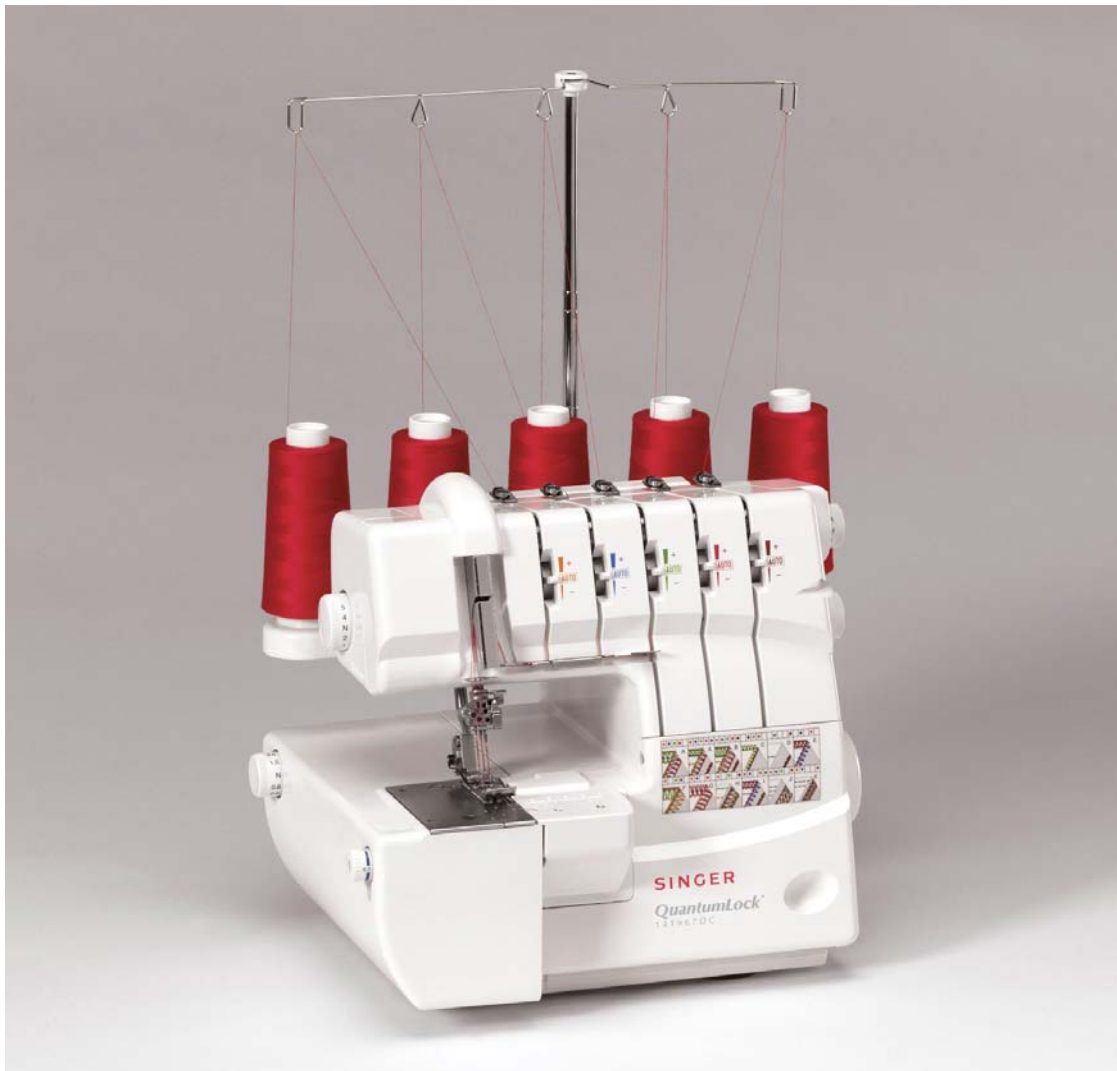

Two-Thread Wrapped Edge Overlock (Narrow)

The Two-Thread Wrapped Edge Overlock provides an elegant fine finish to lightweight fabrics. When using clear threads in conjunction with the Two-Thread stitch, the fabric appears to have an invisible edge. This gives a couture effect and looks beautiful on finer fabrics. The Two-Thread Stitch requires the lower looper thread and one overlock needle thread. The lower looper thread wraps around the fabric's edge. There are 2 different ways to set up for a Two-Thread Wrapped Edge Overlock stitch. For a more narrow stitch (4.0) select the right overedge needle; for a wider stitch(6.0) the left overedge needle is used.



Right Overedge
Needle Thread

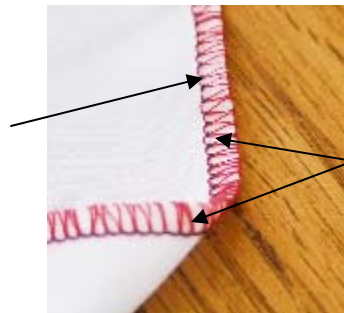

Lower Loper
Thread

Set up:

Needle:

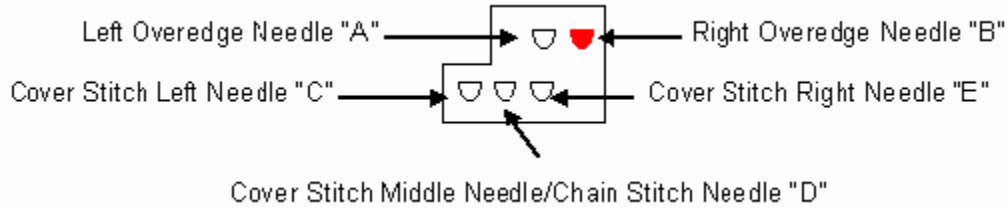

Set at:

ATD: Auto Tension Dial	"D"
Left Cover Stitch Needle "C"	Unthreaded and Remove Needle
Middle Cover Stitch Needle "D"	Unthreaded and Remove Needle
Right Cover Stitch Needle "E"	Unthreaded and Remove Needle
Overedge Left Needle "A"	Unthreaded and Remove Needle
Overedge Right Needle (Blue) "B"	Threaded
Upper Looper	Looper Engaged and Not Threaded
Spreader	Engaged
Lower Looper (Red)	Threaded
Chain Stitch Looper (Brown)	Not Threaded
Upper Knife	Engaged
Seam Guide Plate	Not Installed Use Knife Cover
Seam Width Dial	"N"
Stitch Length Dial	"2"
Presser Foot Pressure	"N"
Differential Feed Dial	"N"
Stitch Finger	"N"

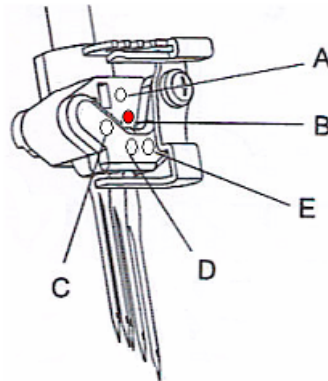

- ◆ Turn Auto Tension Dial to “D”.

- ◆ Turn Stitch Length Dial to “2”.

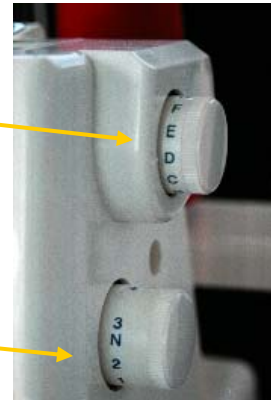

- ◆ Engage Upper Knife. The knife will not trim the fabric when it is disengaged.
 1. Open Looper Cover.
 2. Pull the movable knife holder (silver screw) to the right as far as it will go.
 3. Turn the holder toward clockwise until the knife clicks into a lock position.

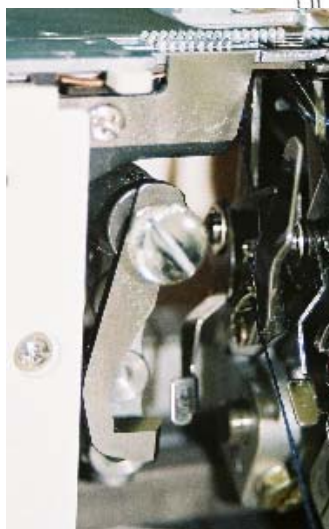
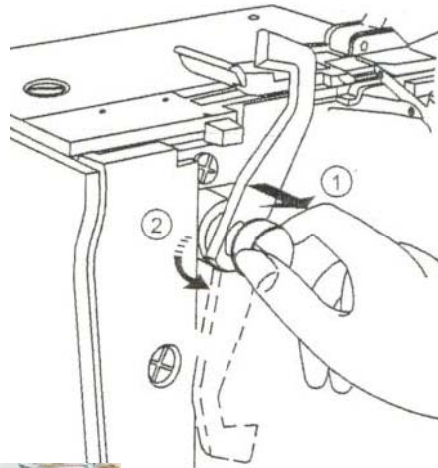

Upper Knife Disengaged



Upper Knife Engaged

- ◆ Turn Presser Foot Pressure Dial to “N”.



- ◆ Turn Differential Feed Dial to “N”.



- ◆ Turn Seam Width Dial to “N”.

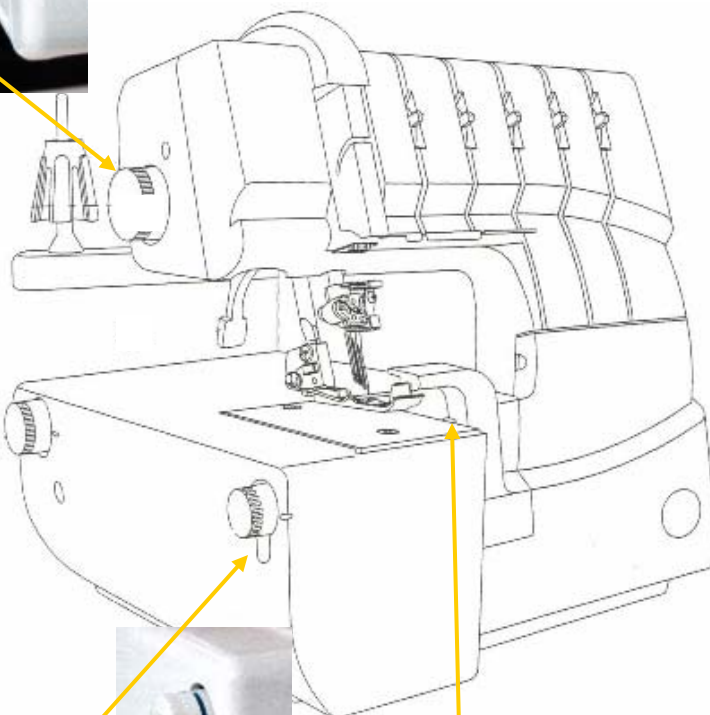

- ◆ Set Stitch Finger to “N”.

◆ Install the Knife Cover.

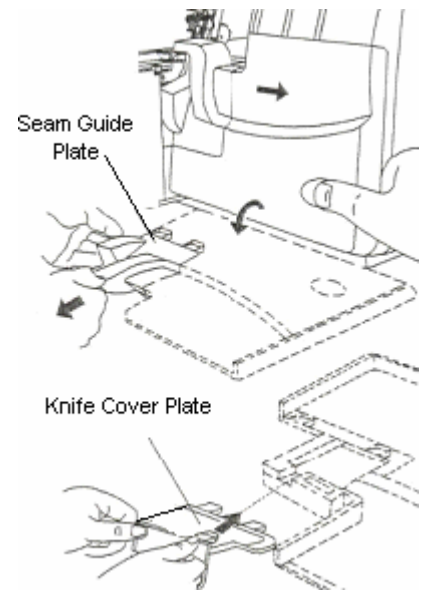

◆ Engage Upper Looter. Engaging the Upper Looter causes the looper to move when sewing. Even though the Upper Looter is not threaded, it needs to be engaged.

1. Push the clutch button to the left and down to engage.
2. Turn handwheel.

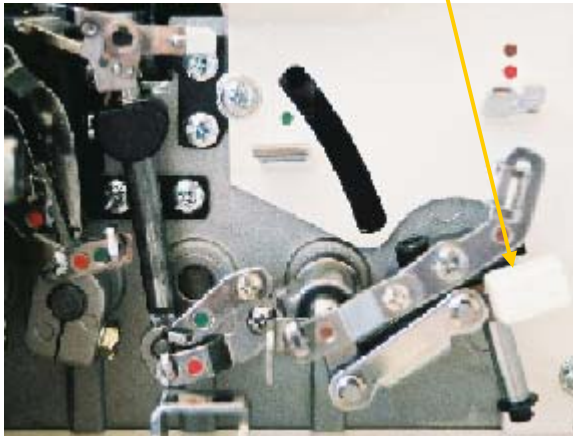

Upper Looter Disengaged

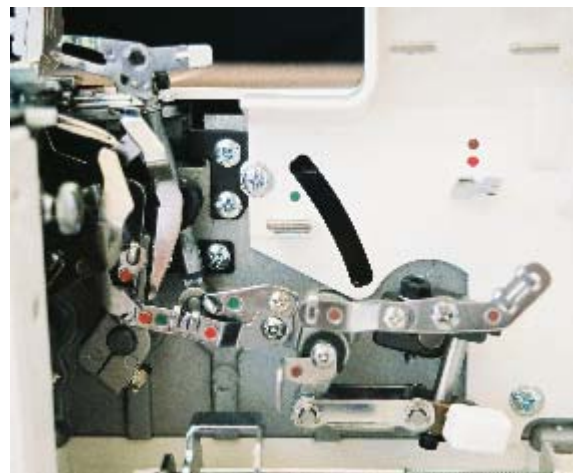
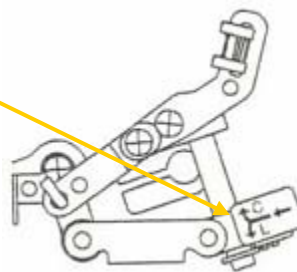

Upper Looter Engaged

- ◆ Engage Spreader. The Upper Loper has a hole for the thread on the top of the looper. If the stitch requires that the looper be engaged, but not threaded then the Spreader is used. The Spreader simply plugs-in (or closes) the looper's hole. The Spreader is disengaged when the Upper Loper is engaged/operative and threaded. The Spreader is used with a stitch that requires only one looper thread. With the help of the Spreader the single looper thread needs to wrap around the fabric's edge.

1. Raise the white handle on the Spreader to insert the tip into the eye of the Upper Loper.

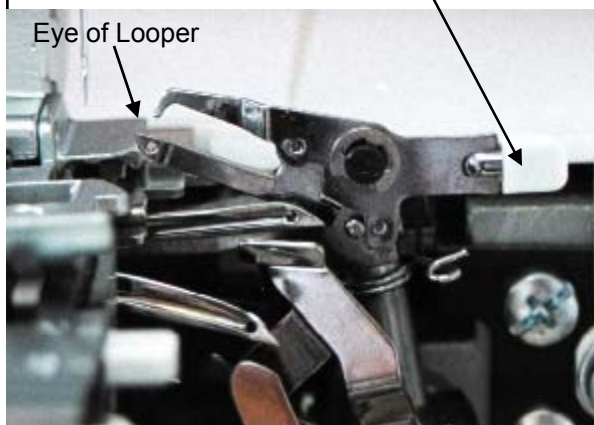

Spreader Disengaged



Spreader Engaged

- ◆ Thread Lower Loper with regular overlock thread.

1. Raise the Presser Foot to release the Tension disks. Thread the Lower Loper as illustrated 1-10.
2. Pass thread from back to the front through the thread guide ①.

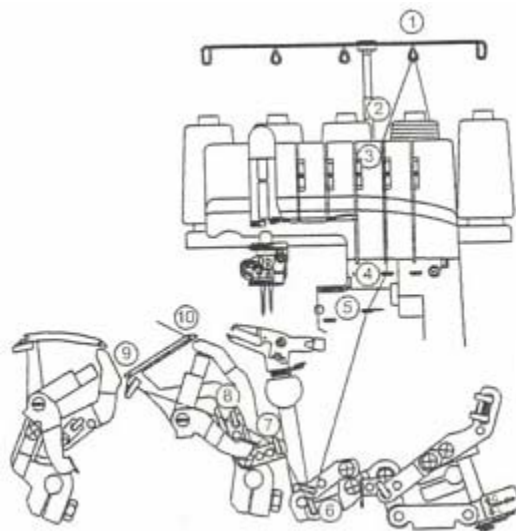
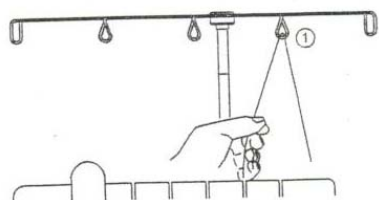

3. Thread the top cover thread guide by pulling the thread towards the left until it slips under the guide. Then pull the thread along the right side of the button as illustrated.

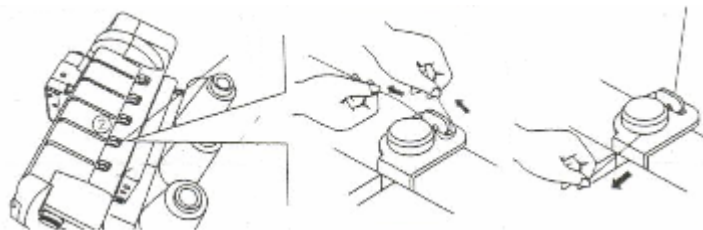

4. While holding the thread firmly, pull the thread between the tension disks.

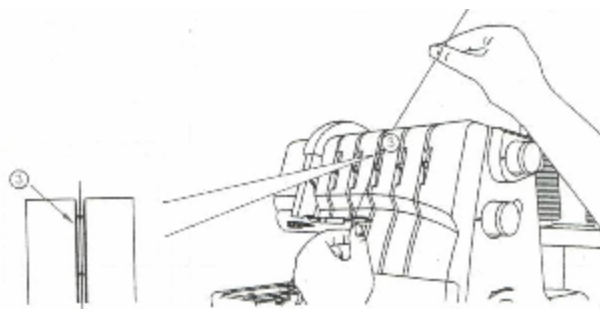

5. Turn the handwheel toward you until the lower looper extends 5-10mm (approximately 1/2 inch) from the needle plate edge.

6. Thread the looper area of the machine following the red color coded thread guides 4-10.

7. Place the thread slightly from left and to the right of threading guide ④.

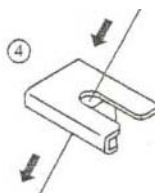

8. Place the thread slightly from the front and to the back of threading guide ⑤.



9. Place the thread through ⑥, ⑦, and ⑧.

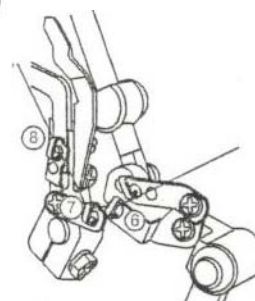

10. Thread the looper eye (A) from front to back. Pull about 4 inches of thread. Position thread into V cutout (B) on threader. Firmly hold thread tail with left hand and pull Threader lever (C) up into place (D).

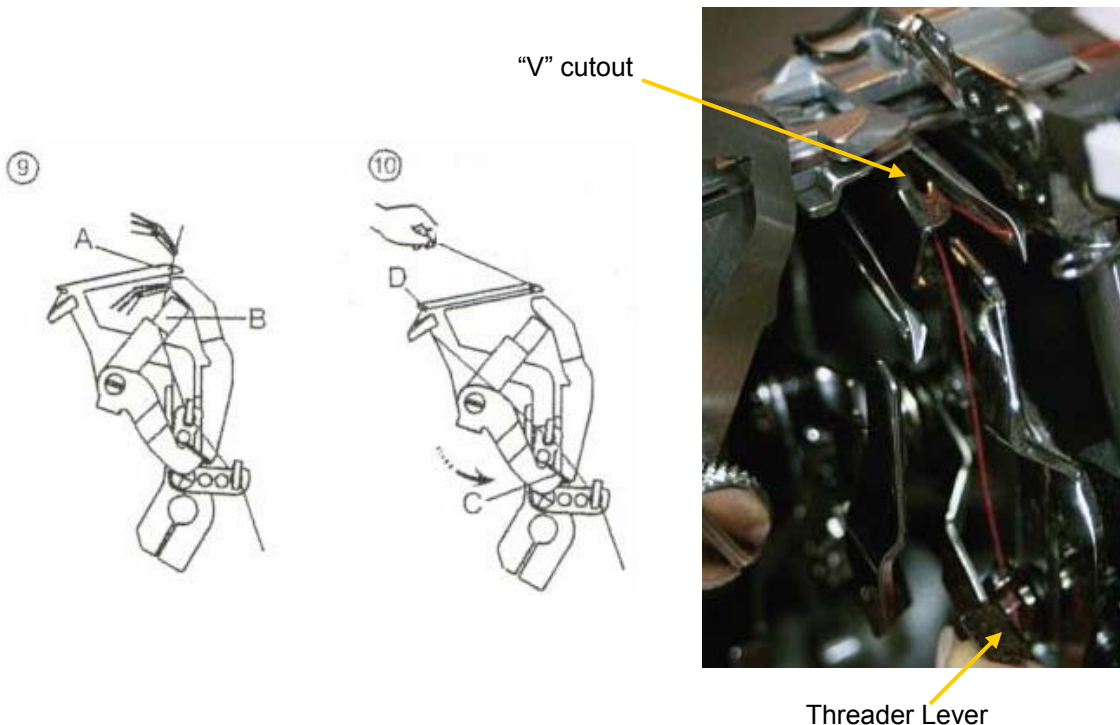

◆ Thread Right Overedge needle with regular thread.

1. Raise the Presser Foot to release the tension discs. Thread the right needle as illustrated 1-9.
2. Pass thread from back to the front through the thread guide ①.

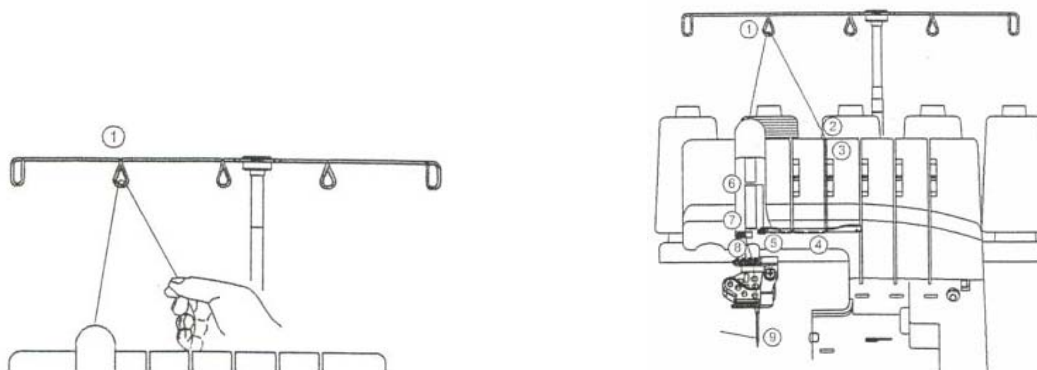

3. Thread the top cover thread guide by pulling the thread towards the left until it slips under the guide. Then pull the thread along the right side of the button as illustrated.

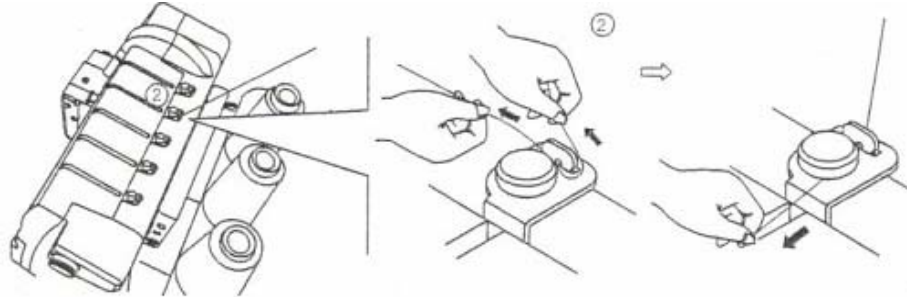

4. Continue to thread points 4-8. Slip the thread into the rear slot of the thread guide ⑤. Go over the take up lever ⑥. Continue by slipping the thread into the right slot of the thread guides ⑦ and ⑧.

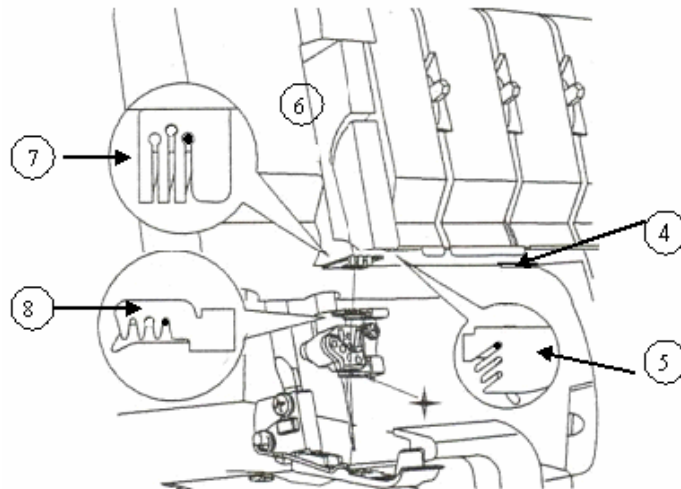

5. Before threading the eye of the needle, make sure the thread is behind the thread guide located on the bottom of the needle clamp.

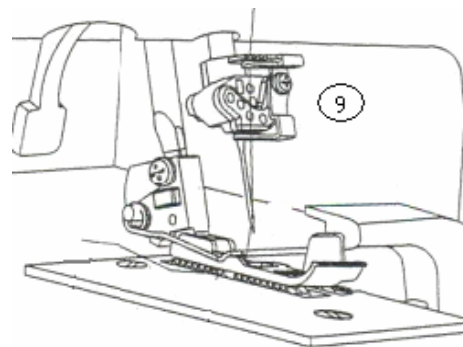
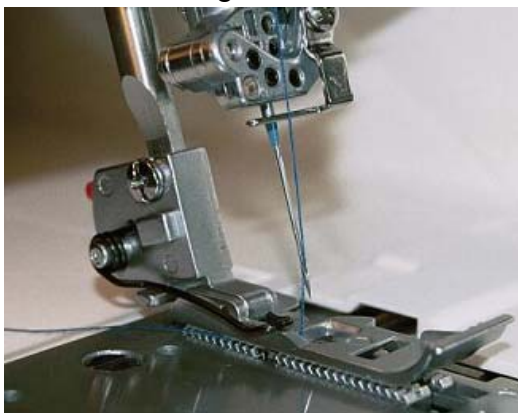

6. Thread the eye of the Right Overedge Needle ⑨.

SINGER®

Try It:

- ◆ Align two pieces of lightweight fabric, right sides together so that the knife just slightly trims the fabric edge.
- ◆ Sew.
- ◆ Press seam to one side.



Two-Thread Wrapped Edge Overlock (wide)

The Two-Thread Wrapped Edge Overlock (wide) has the same set up as the Two-Thread Wrapped Edge Overlock (narrow) Stitch. The only exception is the Right Overedge Needle is now unthreaded and removed and the Left Overedge Needle is threaded. By using the left needle the stitch becomes wider.

SET UP:

Needle:

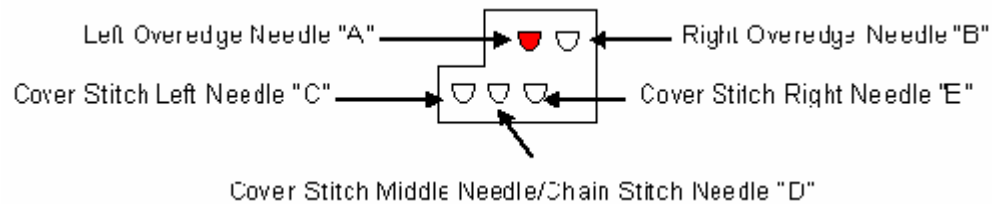

Set at:

ATD: Auto Tension Dial	"D"
Left Cover Stitch Needle (Orange)	Unthreaded and Remove Needle
Middle Cover Stitch Needle (Blue)	Unthreaded and Remove Needle
Right Cover Stitch Needle (Green)	Unthreaded and Remove Needle
Overedge Left Needle (Orange)	Threaded
Overedge Right Needle (Blue)	Unthreaded and Remove Needle
Upper Looper (Green)	Looper Engaged and Not Threaded
Spreader	Engaged
Lower Looper (Red)	Threaded
Chain Stitch Looper (Brown)	Not Threaded
Upper Knife	Engaged
Seam Guide Plate	Not Installed Use Knife Cover
Seam Width Dial	"N"
Stitch Length Dial	"2"
Presser Foot Pressure	"N"
Differential Feed Dial	"N"
Stitch Finger	"N"

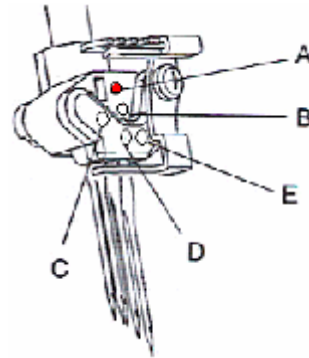

Right Overedge Needle Thread



Left Overedge Needle Thread

◆ Thread Left Overedge needle with regular thread.

1. Raise the Presser Foot to release the tension disks. Thread the left needle as indicated 1-9.

2. Pass thread from back to the front through the thread guide ①.

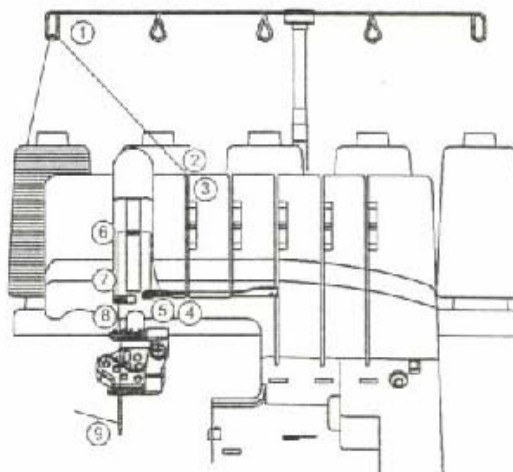
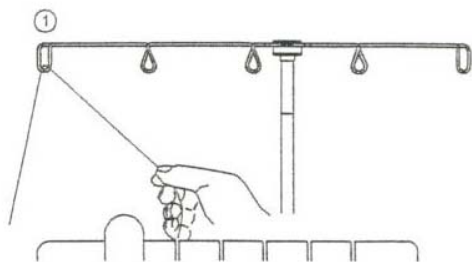

3. Thread the top cover thread guide by pulling the thread towards the left until it slips under the guide. Then pull the thread along the right side of the button as illustrated.

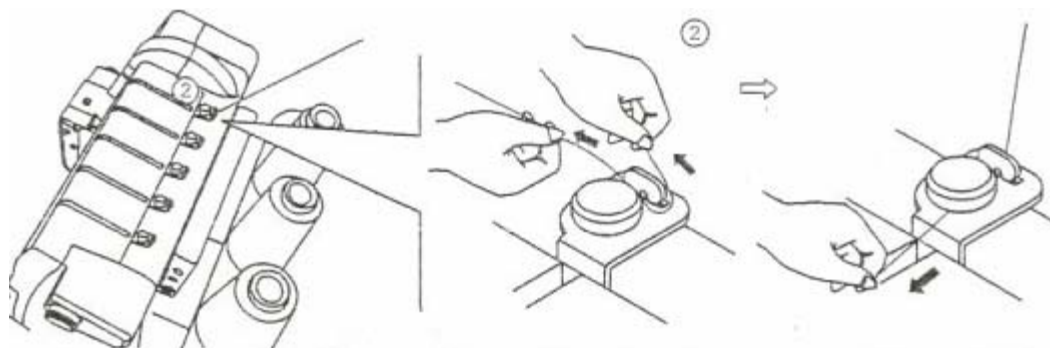

4. While holding the thread firmly, pull the thread between the tension disks.

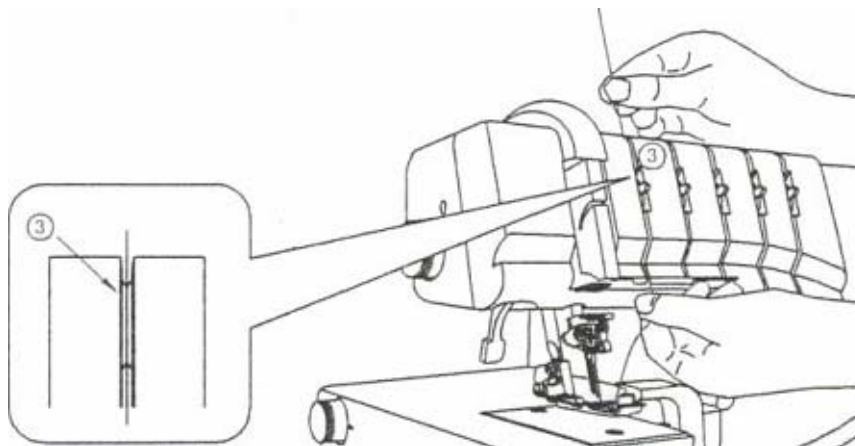

5. Continue to thread points 4-8. Slip the thread into the middle slot of the thread guide ⑤. Go over the take up lever ⑥. Continue by slipping the thread into the middle slot of the thread guides ⑦ and ⑧.
6. Before threading the eye of the needle, make sure the thread is behind the thread guide located on the bottom of the needle clamp.

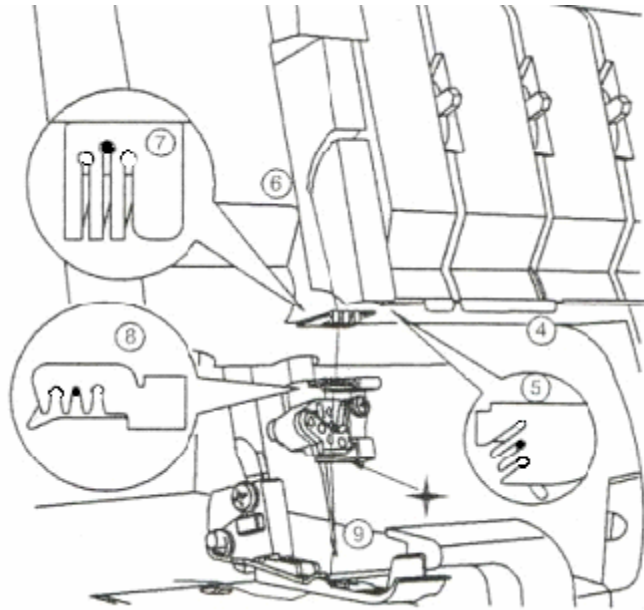

7. Thread the eye of the Left Overedge needle ⑨.
8. Draw about 4 inches of the thread through the needle eye towards the back of the machine.
9. Place the thread to the back, under the Presser Foot.

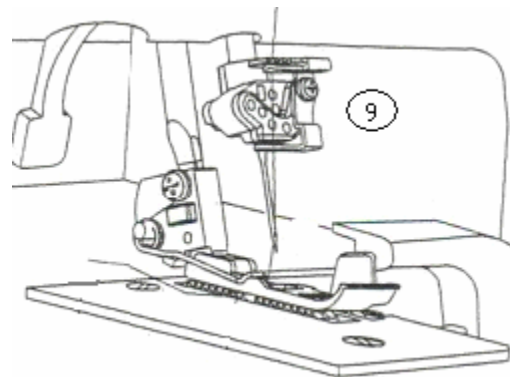

SINGER®

Try It:

- ◆ Align one piece of medium weight fabric so that the knife just slightly trims the fabric edge.
- ◆ Sew.

